

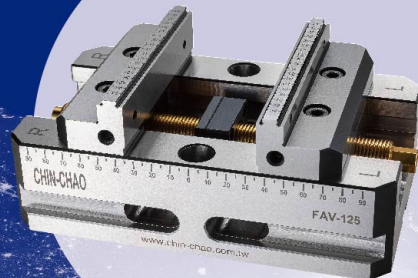

UT-TECH

Precision
Machine
Tools
Production

www.ut-tech.com.tw

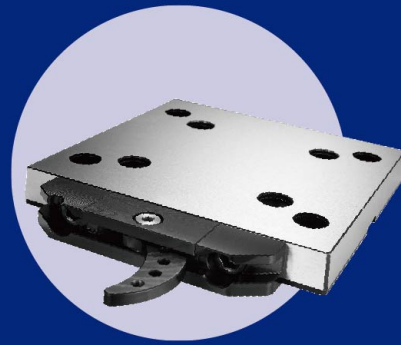



UT-TECH

Company

UT- TECH PRECISION INDUSTRIAL CO., LTD was established in 1981 and has been established for more than 40 years. It is mainly engaged in the production of various precision vises and mechanical accessories. The production plants are located in Taichung City , Taiwan.

Our company is committed to producing high-precision and high-quality products, and continues to invest in product development and innovation. We own ISO certification and numbers of product patents and move towards to an international professional precision vise manufacturer. We care about customer service and product maintenance. , we believe that we can become the best partner for customers in various machining work. UT-TECH products have been sold in more than 40 countries. The Logo of global mark represents the concept of UT-TECH industrial product marketing in the world, and expects to become an excellent and professional company in the future.

Contents

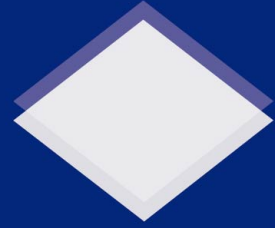

<u>5-Axis Vise</u>	03	●
<u>Zero Point System</u>	09	●
<u>Precision Power Vise</u>	14	●
<u>Pneumatic Super Hi-Pressure Vise</u>	25	●
<u>Rotating Oil Separation System</u>	30	●
<u>Hydraulic Machine Vise</u>	32	●
<u>Angle Lock Machine Vise</u>	34	●
<u>K-Type Machine Vise</u>	37	●
<u>Traditional Machine Vise</u>	38	●
<u>Other Machine Vise</u>	39	●
<u>Special Jaw Plates For Power Machine Vise</u>	41	●



5-AXIS VISE FAV-77

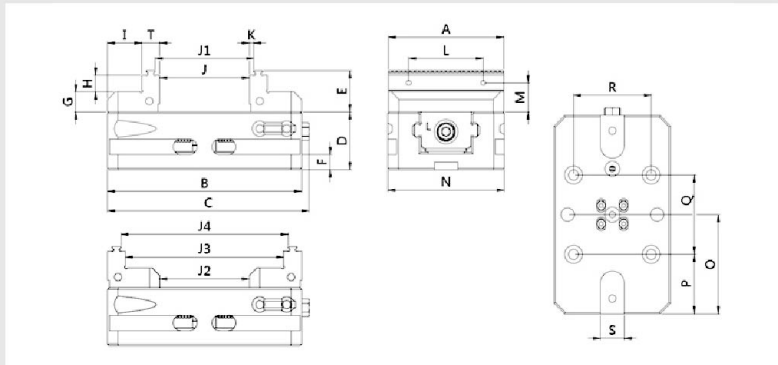

MODEL	A	B	C	D	E	F	G	H
FAV-77	77	130	135	38	27	10	13	11
I	T	K	L	M	N	O	P	Q
23	12	3	135	19	78	65	39	52
R	S	J	J1	J2	J3	J4	Clamping Force	Cross Weight
52	16	60	66	60	106	112	1,100kgf	4kgs

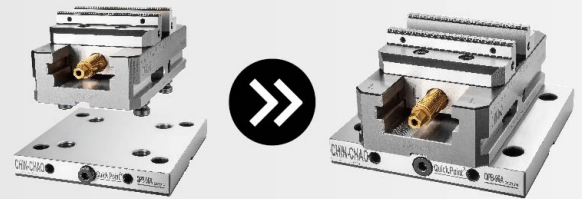
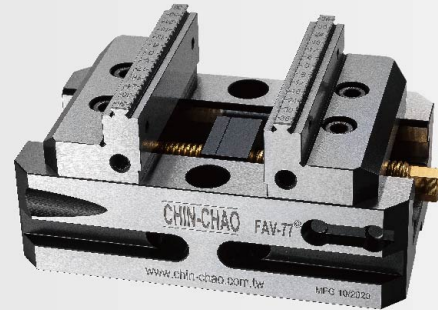

Can be installed with pull bolts and used in conjunction with Zero Point System.

Standard Accessories :

- 1.Ratchet handle x 1 PC
- 2.Guide key x 2 PCS
- 3.M6 x 12L Screw x 2 PCS
- 4.Lock Block x 4 PCS

Optional Accessories:

- Pull Bolts x 4 PCS / Zero Point System

5-AXIS VISE FAV-100

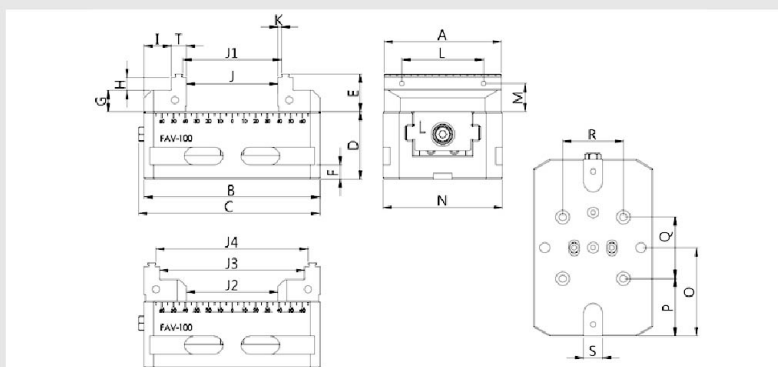

MODEL	A	B	C	D	E	F	G	H
FAV-100	100	150	155	57	32	12	18	11
I	T	K	L	M	N	O	P	Q
23	13	3	70	24	102	75	49	52
R	S	J	J1	J2	J3	J4	Clamping Force	Cross Weight
52	16	78	84	78	124	130	1,300kgf	5.8kgs

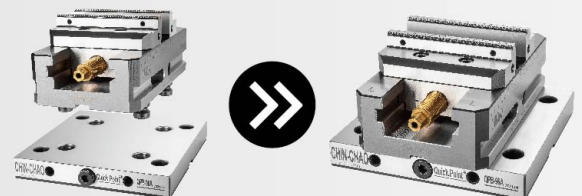
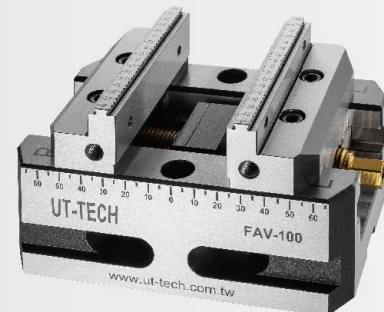

Can be installed with pull bolts and used in conjunction with Zero Point System.

Standard Accessories :

- 1.Ratchet handle x 1 PC
- 2.Guide key x 2 PCS
- 3.M6 x 12L Screw x 2 PCS
- 4.Lock Block x 4 PCS

Optional Accessories:

- Pull Bolts x 4 PCS / Zero Point System



5-AXIS VISE FAV-125

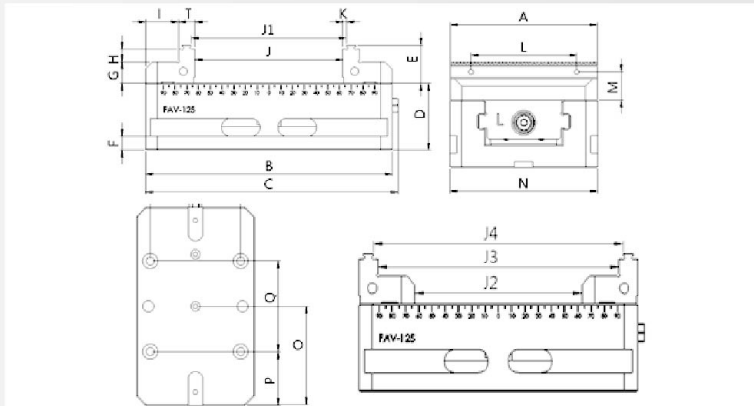

MODEL	A	B	C	D	E	F	G	H
FAV-125	125	210	215	57	32	12	18	11
I	T	K	L	M	N	O	P	Q
28	14	3	90	24	126	104	57	96
R	S	J	J1	J2	J3	J4	Clamping Force	Cross Weight
96	16	126	132	126	182	188	1,500kgf	9.4kgs

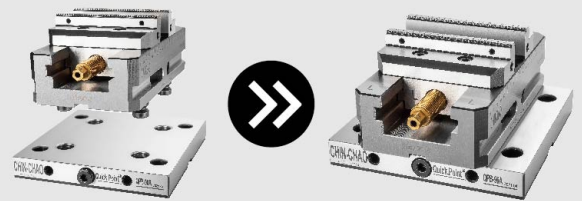
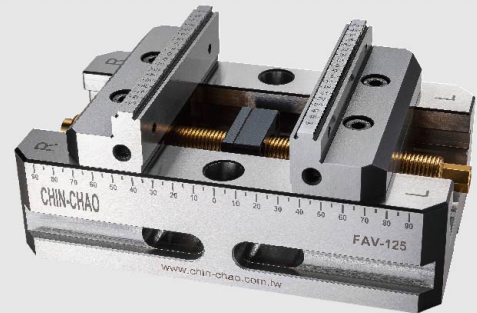

Can be installed with pull bolts and used in conjunction with Zero Point System.

► Standard Accessories :

1. Ratchet handle x 1 PC
2. Guide key x 2 PCS
3. M6 x 12L Screw x 2 PCS
4. Lock Block x 4 PCS

► Optional Accessories:

Pull Bolts x 4 PCS / Zero Point System

4-AXIS VISE FAV-150

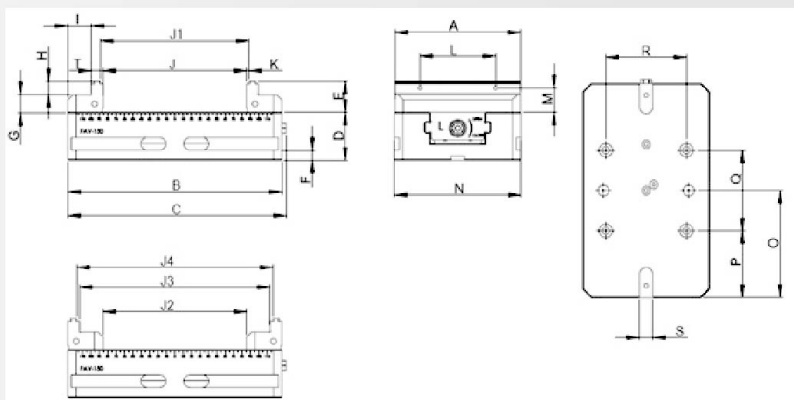

MODEL	A	B	C	D	E	F	G	H
FAV-150	150	255	260	57	37	12	21	16
I	T	K	L	M	N	O	P	Q
28	14	3	90	29	151	127.5	79.5	96
R	S	J	J1	J2	J3	J4	Clamping Force	Cross Weight
96	16	171	177	171	227	233	1,600kgf	15kgs

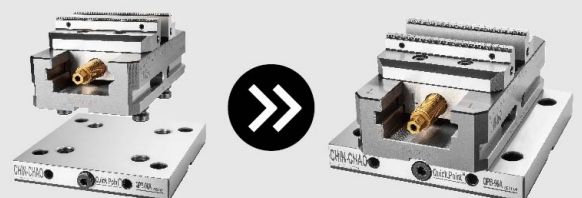
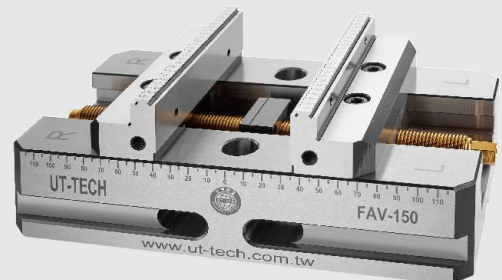

Can be installed with pull bolts and used in conjunction with Zero Point System.

► Standard Accessories :

1. Ratchet handle x 1 PC
2. Guide key x 2 PCS
3. M6 x 12L Screw x 2 PCS
4. Lock Block x 4 PCS

► Optional Accessories:

Pull Bolts x 4 PCS / Zero Point System



5-AXIS PRECISION VISE DOUBLE LOCK DFV-125

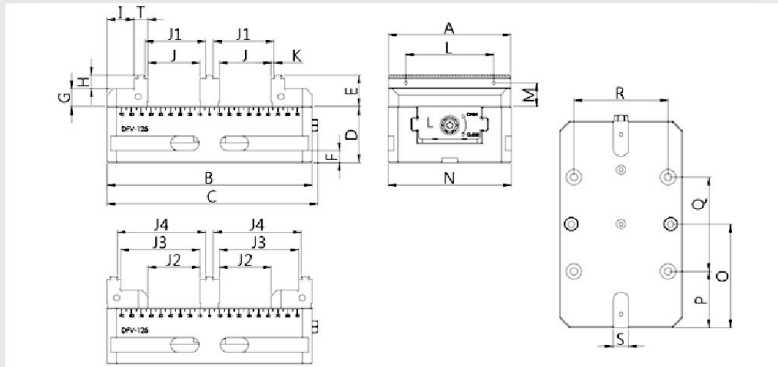

MODEL	A	B	C	D	E	F	G	H
DFV-125	125	210	215.5	57	32	12	18	14
I	T	K	L	M	N	O	P	Q
28	14	3	90	24	126	105	57	96
R	S	J	J1	J2	J3	J4	Clamping Force	Cross Weight
96	16	53	62	53	81	90	1,800kgf	10.6kgs

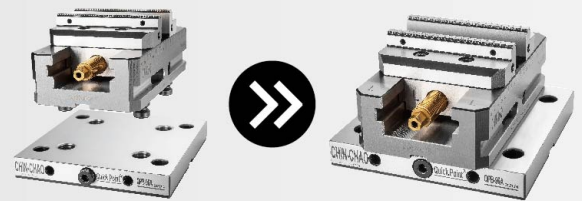
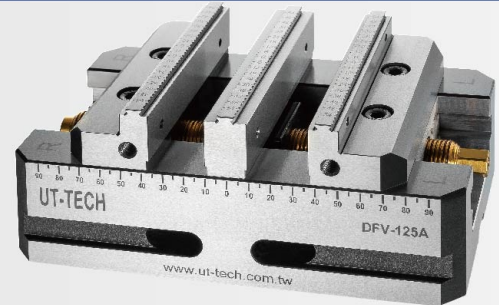

Can be installed with pull bolts and used in conjunction with Zero Point System.

► Standard Accessories :

- 1.Ratchet handle x 1 PC
- 2.Guide key x 2 PCS
- 3.M6 x 12L Screw x 2 PCS
- 4.Lock Block x 4 PCS

► Optional Accessories:

- Pull Bolts x 4 PCS / Zero Point System

5-AXIS VISE FAV-125-310L

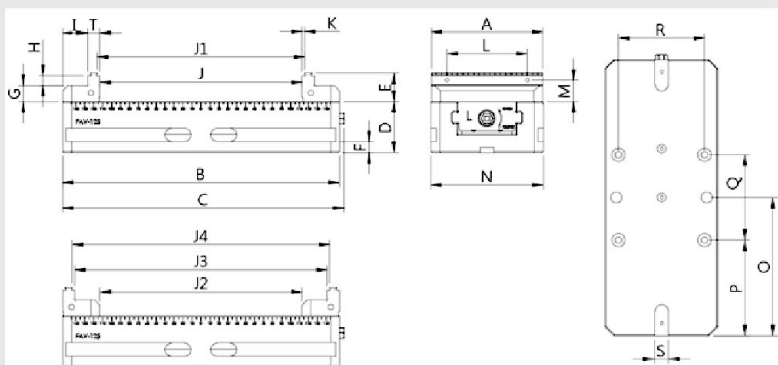

MODEL	A	B	C	D	E	F	G	H
FAV-125-310L	125	310	315	57	32	12	18	11
I	T	K	L	M	N	O	P	Q
28	14	3	90	24	126	155	107	96
R	S	J	J1	J2	J3	J4	Clamping Force	Cross Weight
96	16	226	232	226	282	288	1,800kgf	13.5kgs

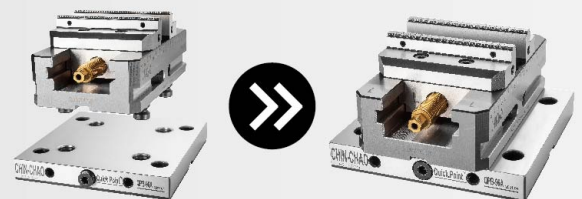
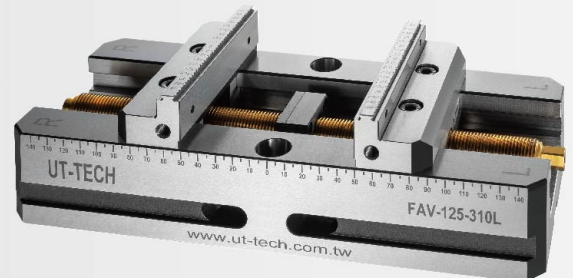

Can be installed with pull bolts and used in conjunction with Zero Point System.

► Standard Accessories :

- 1.Ratchet handle x 1 PC
- 2.Guide key x 2 PCS
- 3.M6 x 12L Screw x 2 PCS
- 4.Lock Block x 4 PCS

► Optional Accessories:

- Pull Bolts x 4 PCS / Zero Point System



Common Features 5-AXIS VISE

- 5-Axis Vise (Self-Centering Vise), with high repeat positioning accuracy (up to 0.01mm) which suitable for precision machining applications in precision 4 and 5-Axis CNC machine tools, rotary tables, or precision vertical/horizontal integrated milling and cutting machining centers.
- The main body and parts are made of high-grade alloy steel and undergo high-quality quenching and hardening heat treatment, providing high strength, wear resistance, and tensile strength characteristics. The vise is subjected to precision processing and grinding at each stage, ensuring high precision of the vise base and clamping surface.
- The screw rod undergoes quenching and high-frequency treatment, followed by high-precision titanium plating treatment, significantly improving the strength and wear resistance of the screw rod.
- The hardness of the jaw plate with heat treatment is HRC45°~48°, capable of clamping high-hardness materials. The serrations on the jaw plate with 45° angle structure strengthen the clamping force.
- The sliding block is designed with additional hole positions, allowing for quick replacement or addition of required jaw plates, to meet various clamping requirements for different workpieces and make the workpiece clamping more diverse and flexible.
- This machine vise offers five different clamping modes (J~J4) for various machining methods and workpiece sizes, providing flexible clamping options.
- The vise can be used with lock blocks and guide keys to mount on a connecting plate, or fixed directly on the worktable surface. As well as use with zero point system is available.
- The height of the vise body has fixed specifications (D), allowing for simultaneous use of multiple units.
- The unique design of the machine vise has a patent pending.

BIG OPEN 5-AXIS PRECISION VISE FAV-220/280

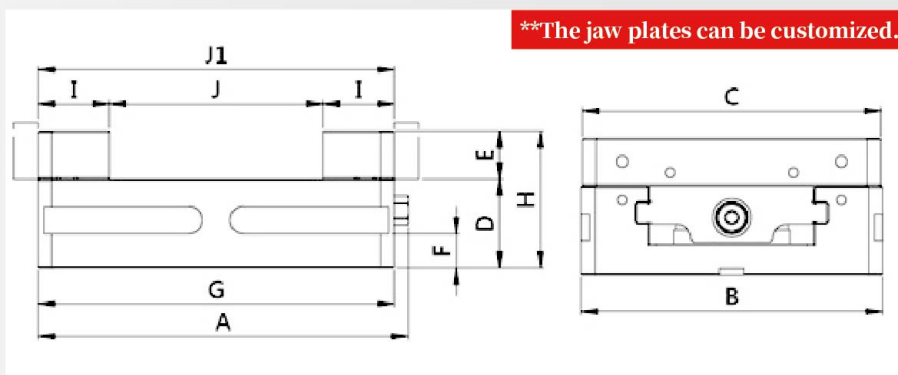

MODEL	A	B	C	D	E	F	G	H	I	J	J1	Clamping Force	Cross Weight
FAV-220	270	220	218	65	35	25	260	100	52	156	260	2,000kgf	32kgs
FAV-280	290	280	278	80	40	25	280	120	62	156	280	2,500kgf	50kgs

► Standard Accessories : 1.Ratchet handle x 1 PC 2.Guide key x 2 PCS 3.M6 x 12L Screw x 2 PCS 4.Lock Block x 4 PCS



FEATURES BIG OPEN 5-AXIS PRECISION VISE

- 5-Axis Vise (Self-Centering Vise), with high repeat positioning accuracy (up to 0.015mm) which suitable for precision machining applications in precision 4 and 5-Axis CNC machine tools, rotary tables, or precision vertical/horizontal integrated milling and cutting machining centers.
- Large opening design, capable of clamping larger workpieces (requires larger work surfaces).
- The main body and parts are made of high-grade alloy steel and undergo high-quality quenching and hardening heat treatment, providing high strength, wear resistance, and tensile strength characteristics. The vise is subjected to precision processing and grinding at each stage, ensuring high precision of the vise base and clamping surface.
- The screw rod undergoes quenching and high-frequency treatment, followed by high-precision titanium plating treatment, significantly improving the strength and wear resistance of the screw rod.
- The hardness of the jaw plate with heat treatment is HRC45°, capable of clamping high hardness materials below HRC40°.
- The sliding block is designed with additional hole positions, allowing for quick replacement or addition of required jaw plates, to meet various clamping requirements for different workpieces and make the workpiece clamping more diverse and flexible.
- This machine vise offers two different clamping modes (J~J1) for various machining methods and workpiece sizes, providing flexible clamping options.
- The vise can be used with lock blocks and guide keys to mount on a connecting plate, or fixed directly on the worktable surface, to save procurement costs.
- The height of the vise body has fixed specifications (D), allowing for simultaneous use of multiple units.
- The unique design of the machine vise has a patent pending.

SINGLE WAY BIG OPEN 5-AXIS VISE FFAV-280

****The jaw plates can be customized.**

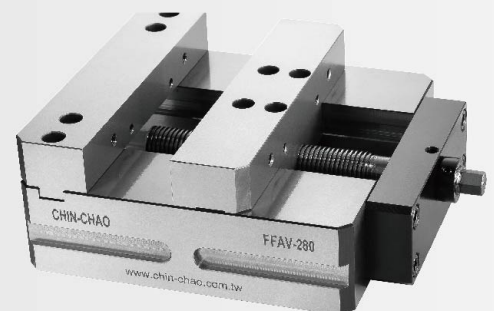
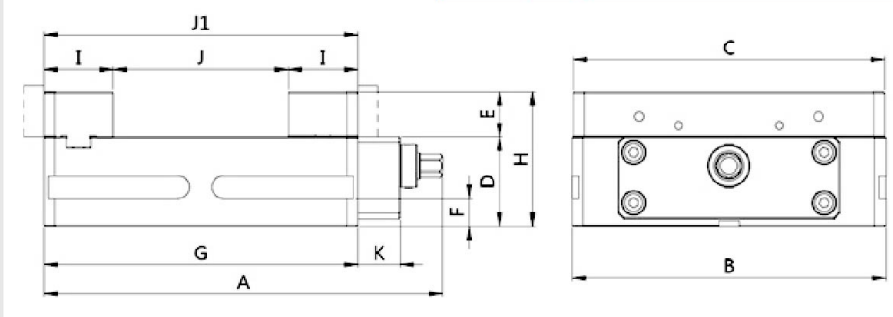

MODEL	A	B	C	D	E	F	G	H	I	J	J1	K	Clamping Force	Cross Weight
FFAV-280	356	280	278	80	40	25	280	120	62	156	280	38	2,500kgf	57kgs

► Standard Accessories : 1.Ratchet handle x 1 PC 2.Guide key x 2 PCS 3.M6 x 12L Screw x 2 PCS 4.Lock Block x 4 PCS



FEATURES SINGLE WAY BIG OPEN 5-AXIS VISE

- Single Way 5-Axis Vise, with high repeat positioning accuracy (up to 0.015mm) which suitable for precision machining applications in precision 4 and 5-Axis CNC machine tools, rotary tables, or precision vertical/horizontal integrated milling and cutting machining centers.
- The screw rod undergoes quenching and high-frequency treatment, significantly improving the strength and wear resistance of the screw rod.
- The hardness of the jaw plate with heat treatment is HRC45°, capable of clamping high hardness materials below HRC40°.
- The sliding block is designed with additional hole positions, allowing for quick replacement or addition of required jaw plates, to meet various clamping requirements for different workpieces and make the workpiece clamping more diverse and flexible.
- This machine vise offers two different clamping modes (J~J1) for various machining methods and workpiece sizes, providing flexible clamping options.
- The height of the vise body has fixed specifications (D), allowing for simultaneous use of multiple units.

SELF CENTERING VISE FCV-100

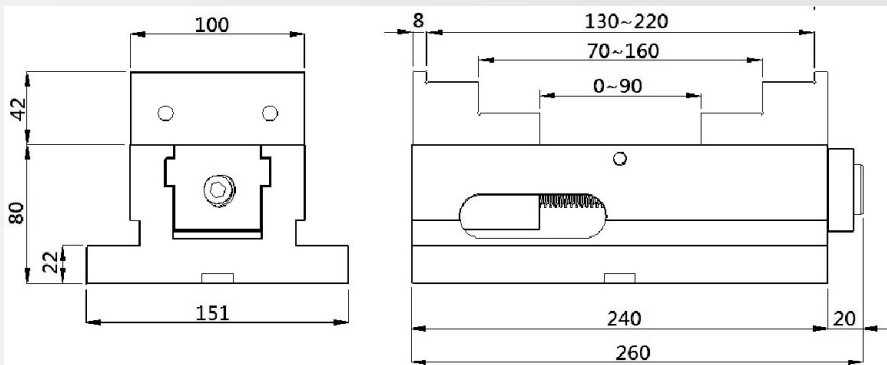

- Standard Accessories :
- 1.Ratchet handle x 1 PC 2.Guide key x 2 PCS
 - 3.M6 x 12L Screw x 2 PCS 4.Lock Block x 4 PCS
- Optional Accessories: Pull Bolts x 4 PCS / Zero Point System

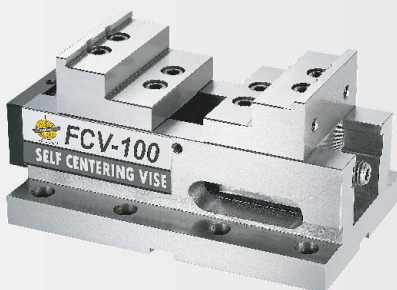

FEATURES

- The compact length is best suited for use with 5-axis machining centers.
- The sliding surface of the vise body undergoes hardening heat treatment (HRC50°) to ensure high precision, high wear resistance, and high tensile strength.
- The design of two-way self-centering enables precise positioning for machining.



ZERO POINT SYSTEM QPB-96A



※ Can be combined the pull bolt with machine vise or other connecting plate for quick positioning.

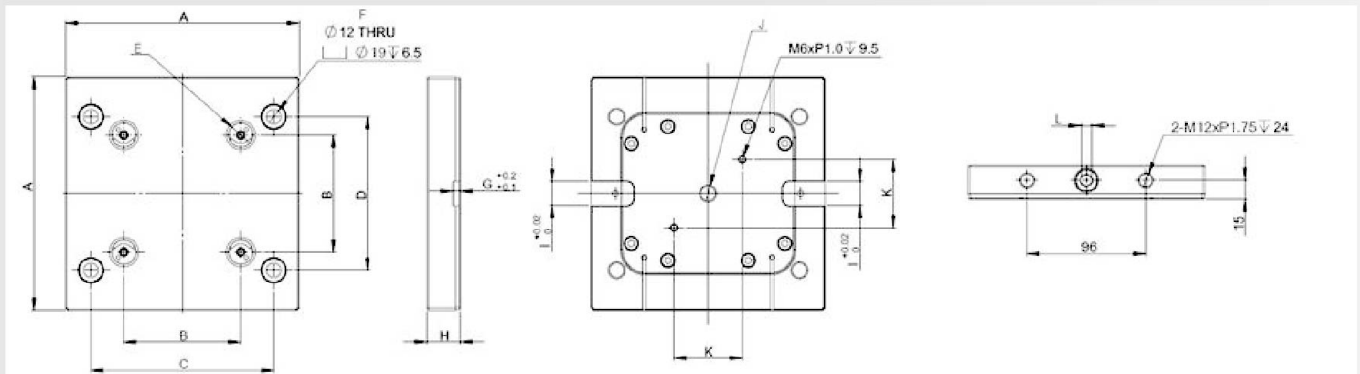

MODEL	A	B	C	D	E	F	G	H	I	J	K	L	Clamping Force	Cross Weight
QPB-96A	192	96	150	126	Ø19.8	M12	6	27	20	12	56	HEX 8	4,800kgf	7 kgs

► Standard Accessories : 1.Ratchet handle x 1 2.Hexagon socket x 1 3.M10x35L Screw x 4
4.Pull Bolts x 4

► Optional Accessories : Quick Point System Set

FEATURES

- 4 pull bolts can provide a clamping force of 4.8 tons (approximately 1.2 tons per stud).
- Zero Point System with a thickness of only 27mm (quick-change fixture device).
- The clamping mechanism, paired with a mechanical wedge pin, allows for simple operation to pull down the bolt for locking operations.
- Even unskilled person can perform quick and precise operations with a repeated positioning accuracy of 0.01mm.
- Capable of supporting various CNC machining center applications (compatible with 4-Axis, 5-Axis Rotary Tables).



ZERO POINT SYSTEM QPB-96B



※ Can be combined the pull bolt with machine vise or other connecting plate for quick positioning.

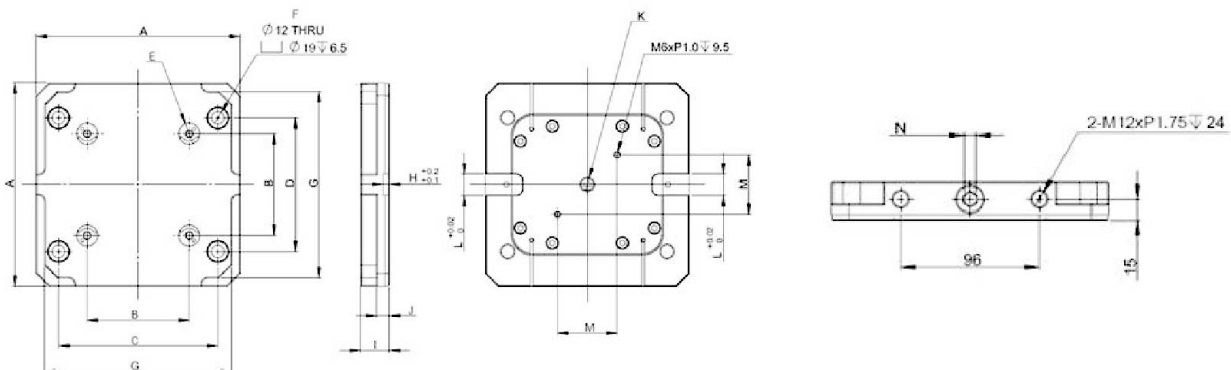

MODEL	A	B	C	D	E	F	G	H	I	J	K	L	M	N	Clamping Force	Cross Weight
QPB-96B	192	96	150	126	Ø19.8	M12	176	6	27	12	12	20	56	HEX 8	4,800kgf	6.4 kgs

► Standard Accessories : 1.Ratchet handle x 1 2.Hexagon socket x 1 3.M10x35L Screw x 4
4. Pull Bolts x 4

► Optional Accessories : Quick Point System Set

FEATURES

- 4 pull bolts can provide a clamping force of 4.8 tons (approximately 1.2 tons per stud).
- Zero Point System with a thickness of only 27mm (quick-change fixture device).
- The clamping mechanism, paired with a mechanical wedge pin, allows for simple operation to pull down the bolt for locking operations.
- Even unskilled person can perform quick and precise operations with a repeated positioning accuracy of 0.01mm.
- Capable of supporting various CNC machining center applications (compatible with 4-Axis, 5-Axis Rotary Tables).



ZERO POINT SYSTEM QPB-96A-Q (Quick Point System Type)

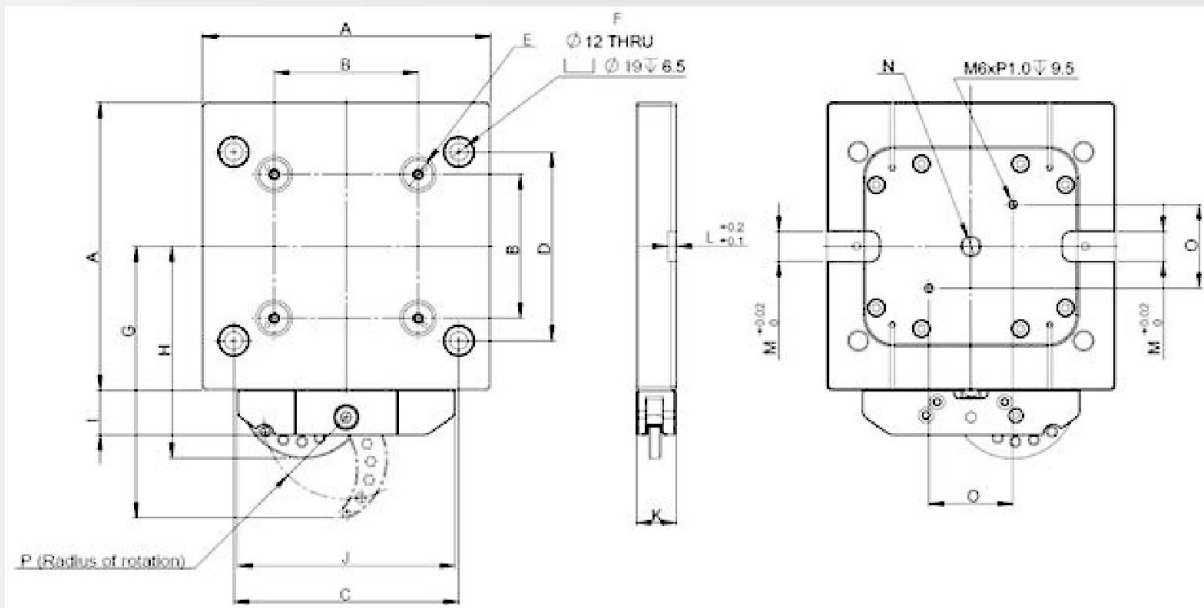

MODEL	A	B	C	D	E	F	G	H	I	J	K	L	M	N	O	P	Clamping Force	Cross Weight
QPB-96A-Q	192	96	150	126	Ø19.8	M12	181	141	30	145	27	6	20	12	56	54.72	4,800kgf	7.74 kgs

► Standard Accessories : 1.Ratchet handle x 1 2.Hexagon socket x 1 3.M10x35L Screw x 4
4.Pull Bolts x 4 5.Ratchet Handle

► Optional Accessories : Quick Point Handle

FEATURES

- 4 pull bolts can provide a clamping force of 4.8 tons (approximately 1.2 tons per stud).
- Zero Point System with a thickness of only 27mm (quick-change fixture device).
- This quick point system, combined with the quick clamping handle set, allows for locking and unlocking operations by simply pulling down the bolt during the pushing and pulling actions. When paired with a robotic arm, it enables automated production.
- Even unskilled person can perform quick and precise operations with a repeated positioning accuracy of 0.01mm.
- Capable of supporting various CNC machining center applications (compatible with 4-Axis, 5-Axis Rotary Tables).



ZERO POINT SYSTEM QPB-96B-Q (Quick Point System Type)

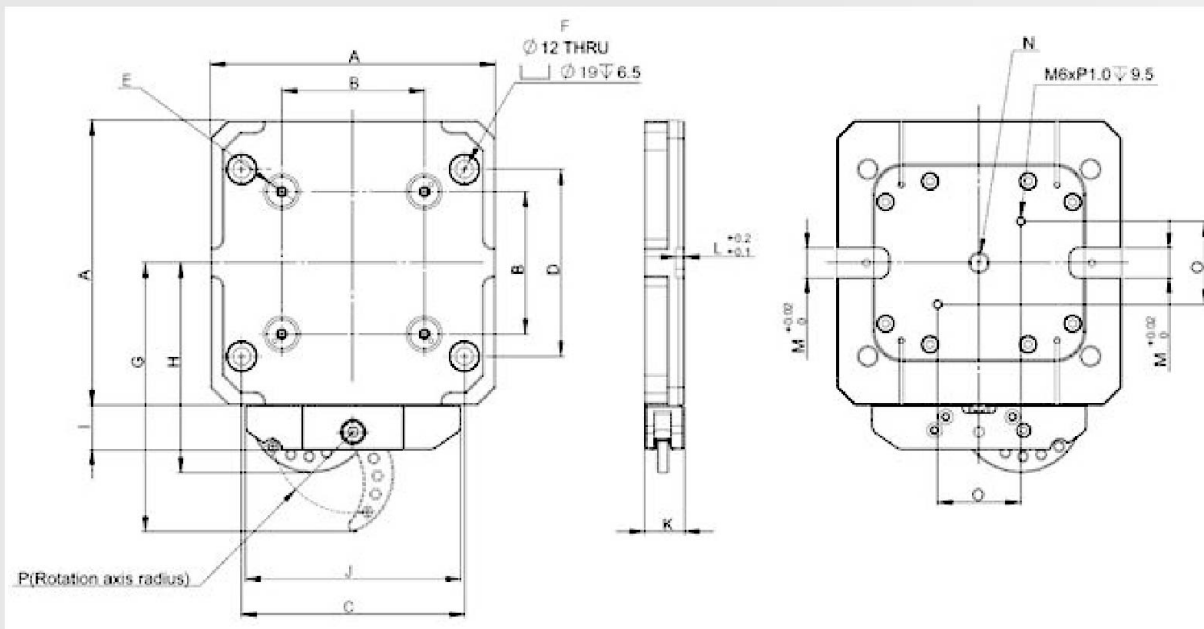

MODEL	A	B	C	D	E	F	G	H	I	J	K	L	M	N	O	P	Clamping Force	Cross Weight
QPB-96B-Q	192	96	150	126	Ø19.8	M12	181	141	30	145	27	6	20	12	56	54.72	4,800kgf	7kgs

- ▶ Standard Accessories : 1.Ratchet handle x 1 2.Hexagon socket x 1 3.M10x35L Screw x 4
4.Pull Bolts x 4 5.Ratchet Handle
- ▶ Optional Accessories : Quick Point Handle

FEATURES

- 4 pull bolts can provide a clamping force of 4.8 tons (approximately 1.2 tons per stud).
- Zero Point System with a thickness of only 27mm (quick-change fixture device).
- This quick point system, combined with the quick clamping handle set, allows for locking and unlocking operations by simply pulling down the bolt during the pushing and pulling actions. When paired with a robotic arm, it enables automated production.
- Even unskilled person can perform quick and precise operations with a repeated positioning accuracy of 0.01mm.
- Capable of supporting various CNC machining center applications (compatible with 4-Axis, 5-Axis Rotary Tables).



UT-TECH www.ut-tech.com.tw

※Pairing with this quick point set enhances the quick changeover system, making it faster and easier.

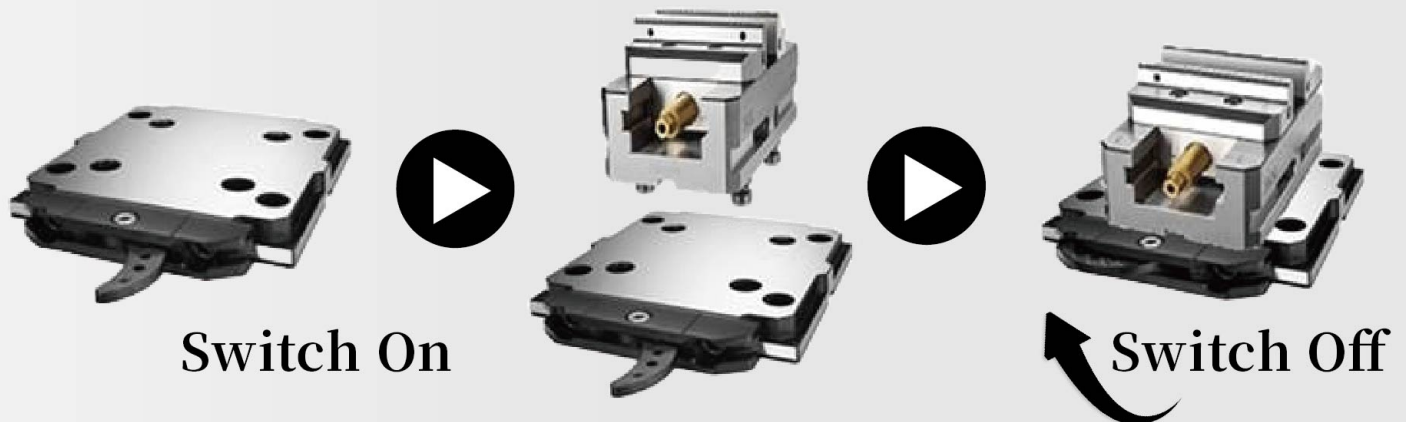

※Pairing with the quick point handle to facilitate the operation of the Zero Point System to make it faster and more convenient.

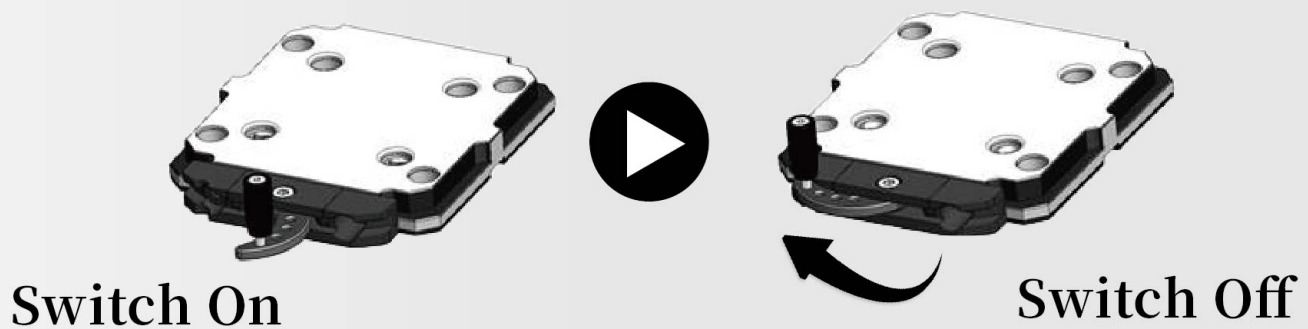

※With Zero Point System combined with a robotic arm, automated production can be achieved, saving mold changeover time and making production faster and more efficient.

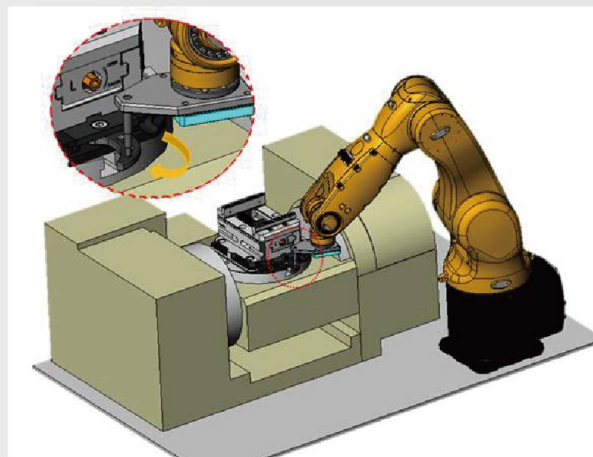



MC POWER MACHINE VISE MACHINE TYPE MPPV



Four clamping ways for choice

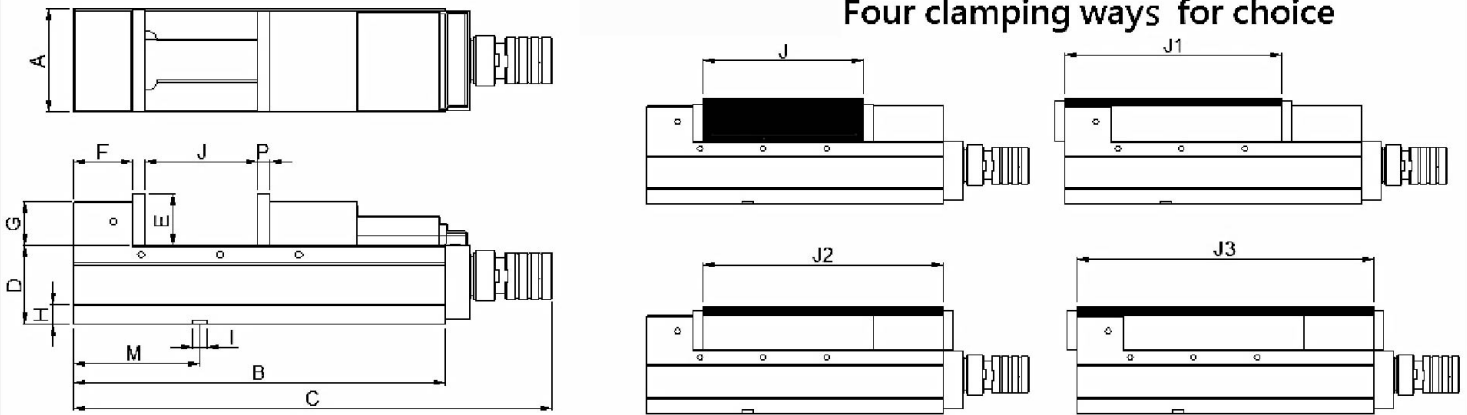

MODEL	A	B	C	D	E	F	G	H	I	M	P	J	J ₁	J ₂	J ₃	Clamping Force (kgf)	Weight (Kg)
MPPV-100A	100	395	530	85	53	60	50	25	18	110	15	200	280	320	390	3,500	28
MPPV-130A	130	470	605	100	58	75	55	25	18	160	15	250	340	370	460	4,500	45
MPPV-160A	160	545	680	100	63	80	60	25	18	200	18	300	390	430	530	5,000	64
MPPV-160S	160	488	622	100	63	80	60	25	18	200	18	250	350	390	480	5,000	58
MPPV-160L	160	750	885	100	63	90	60	25	18	200	18	500	580	610	700	5,000	72
MPPV-200A	200	605	740	110	63	95	60	25	18	220	18	340	460	490	600	5,500	86

FEATURES

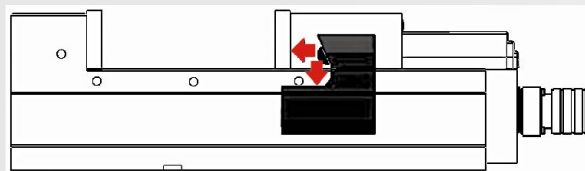

- Standard Accessories :
- 1.Ratchet Handle x1pc
 - 2.Guide Key x2 pcs
 - 3.Screw M6x12L x2 pcs
 - 4.Locked Block x4 pcs

- Machine vise is processed and ground with precision in various ways, suitable for precision machining in vertical/horizontal integrated milling and cutting machine centers.
- The main body of the vise is made of high ductility nodular cast iron (FCD600) with integrated molding design. The sliding surfaces undergo harden heat treatment (HRC50°) to ensure high precision, high wear resistance, and high tensile strength.
- The hardness of the jaw plates after heat treatment is HRC55°.
- The semi-spherical ball can generate angular locking force, which can eliminate workpiece lifting.
- Unique mechanical pressurization mechanism design (patented design), featuring rapid pressurization and high clamping force (max to 5,500kgf).
- This machine vise can be used in four different clamping modes.
- This machine vise features a chipsproof design, which prevents iron chips from entering the interior of the vise and easy discharge of chips, thus extending its lifespan.
- The height (D) of the vise is fixed, allowing for multiple units to be used in parallel.



MC POWER MACHINE VISE HYDRAULIC TYPE HPPV



Four clamping ways for choice

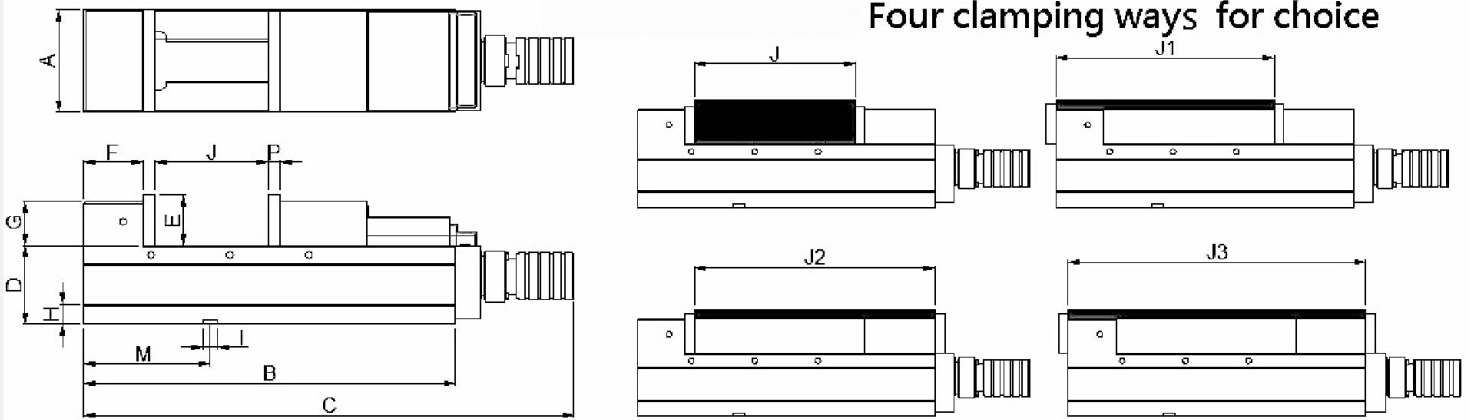

MODEL	A	B	C	D	E	F	G	H	I	M	P	J	J ₁	J ₂	J ₃	Clamping Force (kgf)	Weight (Kg)
HPPV-100A	100	395	552	85	53	60	50	25	18	110	15	200	280	320	390	3,500	29
HPPV-130A	130	470	626	100	58	75	55	25	18	160	15	250	340	370	460	4,500	46
HPPV-160A	160	545	702	100	63	80	60	25	18	200	18	300	390	430	530	5,000	65
HPPV-160S	160	488	644	100	63	80	60	25	18	200	18	250	350	390	480	5,000	59
HPPV-160L	160	750	907	100	63	80	60	25	18	200	18	500	580	610	700	5,000	73
HPPV-200A	200	605	762	110	63	95	60	25	18	220	18	340	460	490	600	5,500	87

FEATURES

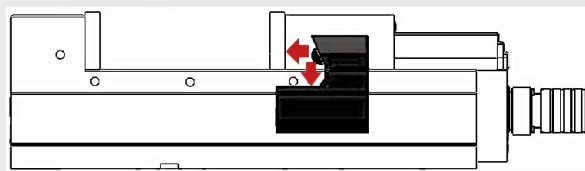

- Standard Accessories :
- 1.Ratchet Handle x1pc
 - 2.Guide Key x2 pcs
 - 3.Screw M6x12L x2 pcs
 - 4.Locked Block x4 pcs

- Machine vise is processed and ground with precision in various ways, suitable for precision machining in vertical/horizontal integrated milling and cutting machine centers.
- The main body of the vise is made of high ductility nodular cast iron (FCD600) with integrated molding design. The sliding surfaces undergo harden heat treatment (HRC50°) to ensure high precision, high wear resistance, and high tensile strength.
- The hardness of the jaw plates after heat treatment is HRC55°
- The semi-spherical ball can generate angular locking force, which can eliminate workpiece lifting.
- Unique hydraulic pressurization mechanism design (patented design), featuring rapid pressurization and high clamping force (max to 5,500kgf).
- This machine vise can be used in four different clamping modes.
- This machine vise features a chipsproof design, which prevents iron chips from entering the interior of the vise and easy discharge of chips, thus extending its lifespan.
- The height (D) of the vise is fixed, allowing for multiple units to be used in parallel.



MC POWER MACHINE VISE ADJUSTABLE TYPE APPV

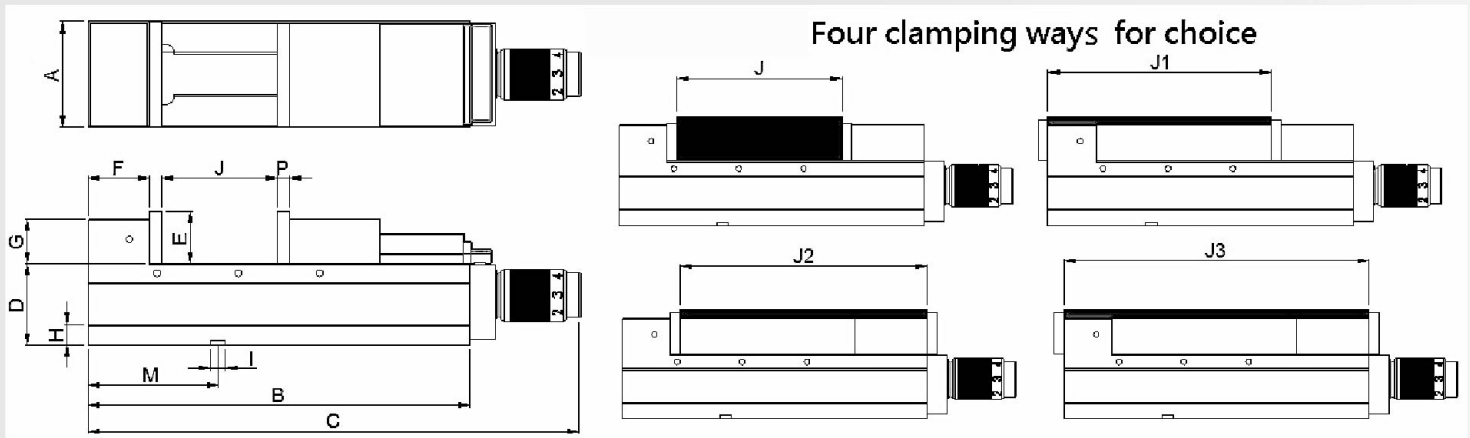

MODEL	A	B	C	D	E	F	G	H	I	M	P	J	J ₁	J ₂	J ₃	Clamping Force (kgf)	Weight (Kg)
APPV-100A	100	395	527	85	53	60	50	25	18	110	15	200	280	320	390	3,500	28
APPV-130A	130	470	602	100	58	75	55	25	18	160	15	250	340	370	460	4,500	45
APPV-160A	160	545	677	100	63	80	60	25	18	200	18	300	390	430	530	5,000	64
APPV-160S	160	488	620	100	63	80	60	25	18	200	18	250	350	390	480	5,000	58
APPV-160L	160	750	882	110	63	90	60	25	18	220	18	500	580	610	700	5,000	72
APPV-200A	200	605	737	110	63	95	60	25	18	220	18	340	460	490	600	5,500	86

FEATURES

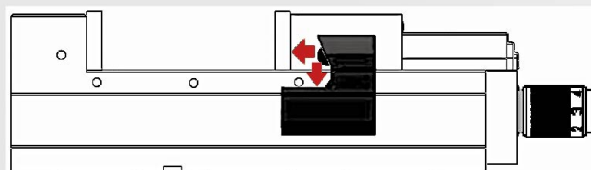

- Standard Accessories :
- 1.Ratchet Handle x1pc
 - 2.Guide Key x2 pcs
 - 3.Screw M6x12L x2 pcs
 - 4.Locked Block x4 pcs

- Machine vise is processed and ground with precision in various ways, suitable for precision machining in vertical/horizontal integrated milling and cutting machine centers.
- The main body of the vise is made of high ductility nodular cast iron (FCD600) with integrated molding design. The sliding surfaces undergo harden heat treatment (HRC50°) to ensure high precision, high wear resistance, and high tensile strength.
- The hardness of the jaw plates after heat treatment is HRC55°
- The semi-spherical ball can generate angular locking force, which can eliminate workpiece lifting.
- Unique segmented pressurization mechanism design (patented design), adjustable to four stages of pressurization force, enabling optimal pressure adjustment for different workpieces or processing methods, featuring by rapid pressurization and high clamping force (up to 5,500kgf)
- This machine vise can be used in four different clamping modes.
- This machine vise features a chipsproof design, which prevents iron chips from entering the interior of the vise and easy discharge of chips, thus extending its lifespan.
- The height (D) of the vise is fixed, allowing for multiple units to be used in parallel.



MC PRECISION MACHINE VISE MV



Four clamping way for choice

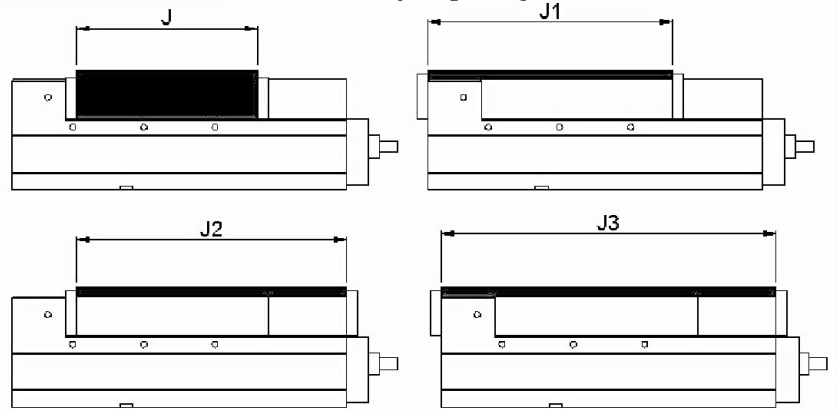
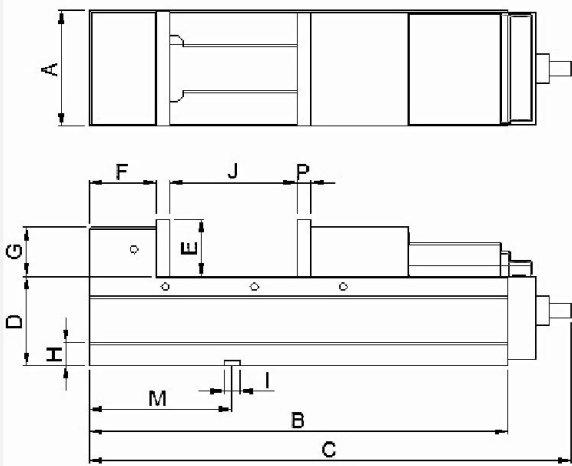

MODEL	A	B	C	D	E	F	G	H	I	M	P	J	J ₁	J ₂	J ₃	Weight (Kg)
MV-100A	100	395	485	85	53	60	50	25	18	110	15	200	270	310	380	26
MV-130A	130	470	560	100	58	75	55	25	18	160	15	250	330	360	450	44
MV-160A	160	545	635	100	63	80	60	25	18	200	18	300	380	420	520	63
MV-160S	160	488	580	100	63	80	60	25	18	200	18	250	340	380	470	57
MV-200A	200	605	695	110	63	95	60	25	18	220	18	340	460	490	600	84

FEATURES

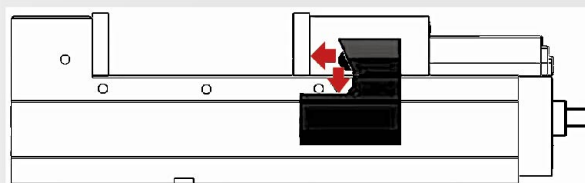

- Standard Accessories :
- 1.Ratchet Handle x1pc
 - 2.Guide Key x2 pcs
 - 3.Screw M6x12L x2 pcs
 - 4.Locked Block x4 pcs

- Machine vise is processed and ground with precision in various ways, suitable for precision machining in vertical/horizontal integrated milling and cutting machine centers.
- The main body of the vise is made of high ductility nodular cast iron (FCD600) with integrated molding design. The sliding surfaces undergo harden heat treatment (HRC50°) to ensure high precision, high wear resistance, and high tensile strength.
- The hardness of the jaw plates after heat treatment is HRC55°
- The semi-spherical ball can generate angular locking force, which can eliminate workpiece lifting.
- This machine vise can be used in four different clamping modes.
- This machine vise features a chipsproof design, which prevents iron chips from entering the interior of the vise and easy discharge of chips, thus extending its lifespan.
- The height (D) of the vise is fixed, allowing for multiple units to be used in parallel.



CNC POWER MACHINE VISE MACHINE TYPE MFPV



Four clamping ways for choice

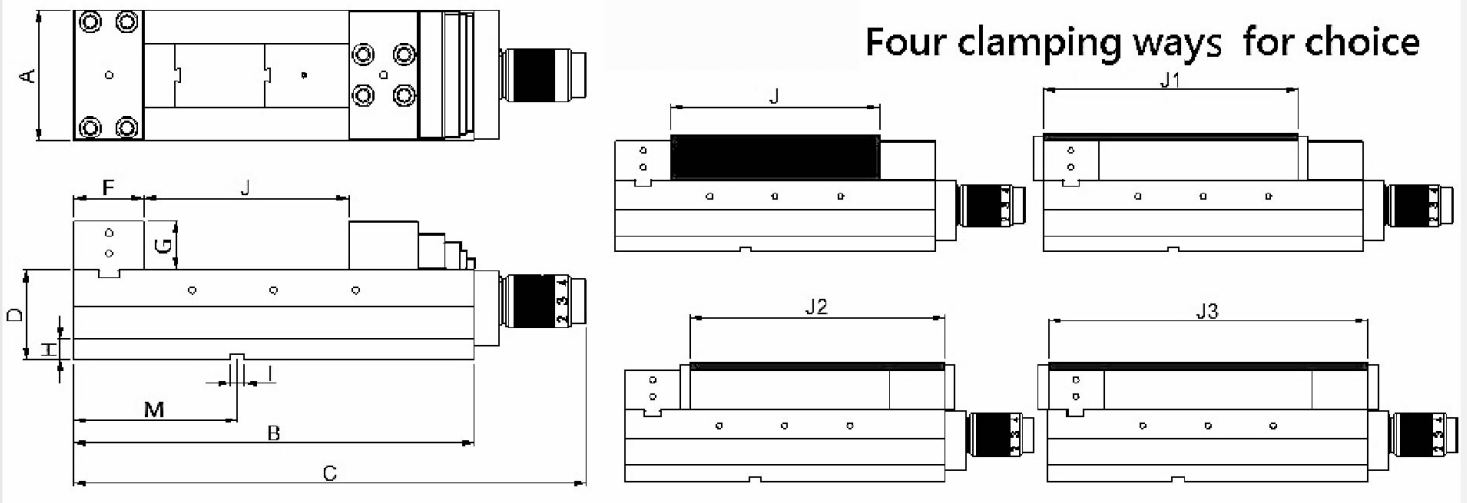

MODEL	A	B	C	D	F	G	H	I	M	J	J ₁	J ₂	J ₃	Clamping Force (kgf)	Weight (Kg)
MFPV-100	100	310	445	85	75	50	25	18	110	150	210	210	300	3,500	30
MFPV-130	130	410	545	100	80	55	25	18	135	240	300	300	400	4,500	45
MFPV-160	160	490	625	110	85	60	25	18	200	300	380	380	480	5,000	64
MFPV-160L	160	550	685	110	85	60	25	18	200	360	440	440	540	5,000	69
MFPV-200	200	530	665	110	85	60	25	18	220	350	420	420	520	5,500	86

FEATURES

- ▶ Standard Accessories :
1.Ratchet Handle x1pc 2.Guide Key x2 pcs 3.Screw M6x12L x2 pcs 4.Locked Block x4 pcs
- ▶ Optional Accessories : vise jaws

- Machine vise is processed and ground with precision in various ways, suitable for precision machining in vertical/horizontal integrated milling and cutting machine centers.
- The main body of the vise is made of high ductility nodular cast iron (FCD600) with integrated molding design. The sliding surfaces undergo harden heat treatment (HRC50°) to ensure high precision, high wear resistance, and high tensile strength.
- Both fixed block and sliding block are made of steel and heat treatment to a hardness of over HRC50°, providing high hardness and wear resistance. Users can add or replace different sizes of jaw plates according to machining requirements.
- This machine vise can be used in four different clamping modes.
- Unique mechanical pressurization mechanism design (patented design), featuring rapid pressurization and high clamping force (max to 5,500kgf).
- This machine vise features a chipsproof design, which prevents iron chips from entering the interior of the vise, thus extending its lifespan.
- The height (D) of the vise is fixed, allowing for multiple units to be used in parallel.



CNC POWER MACHINE VISE HYDRAULIC TYPE HFPV



Four clamping ways for choice

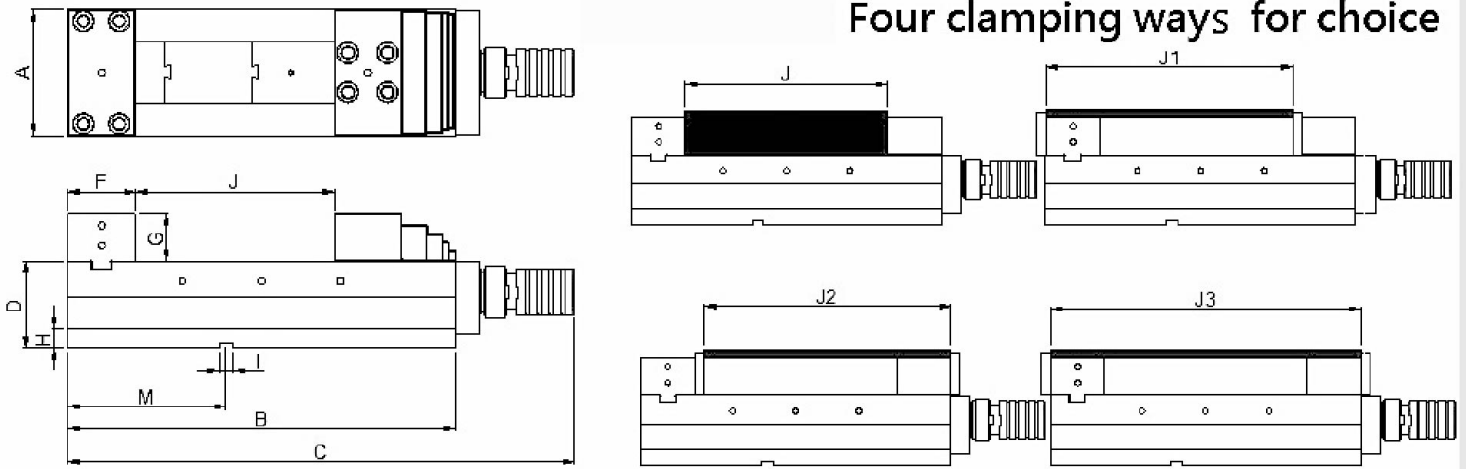

MODEL	A	B	C	D	F	G	H	I	M	J	J ₁	J ₂	J ₃	Clamping Force (kgf)	Weight (Kg)
HFPV-100	100	310	466	85	75	50	25	18	110	150	210	210	300	3,500	30
HFPV-130	130	410	566	100	80	55	25	18	135	240	300	300	400	4,500	45
HFPV-160	160	490	646	110	85	60	25	18	200	300	380	380	480	5,000	65
HFPV-160L	160	550	706	110	85	60	25	18	200	360	440	440	540	5,000	69
HFPV-200	200	530	686	110	85	60	25	18	220	350	420	420	520	5,500	87

FEATURES

► Standard Accessories :

1.Ratchet Handle x1pc 2.Guide Key x2 pcs 3.Screw M6x12L x2 pcs 4.Locked Block x4 pcs

► Optional Accessories : vise jaws

- Machine vise is processed and ground with precision in various ways, suitable for precision machining in vertical/horizontal integrated milling and cutting machine centers.
- The main body of the vise is made of high ductility nodular cast iron (FCD600) with integrated molding design. The sliding surfaces undergo harden heat treatment (HRC50°) to ensure high precision, high wear resistance, and high tensile strength.
- Both fixed block and sliding block are made of steel and heat treatment to a hardness of over HRC50°, providing high hardness and wear resistance. Users can add or replace different sizes of jaw plates according to machining requirements.
- This machine vise can be used in four different clamping modes.
- Unique hydraulic pressurization mechanism design (patented design), featuring rapid pressurization and high clamping force (max to 5,500kgf).
- This machine vise features a chipsproof design, which prevents iron chips from entering the interior of the vise, thus extending its lifespan.
- The height (D) of the vise is fixed, allowing for multiple units to be used in parallel.



CNC POWER MACHINE VISE - ADJUSTABLE TYPE AFPV



Four clamping ways for choice

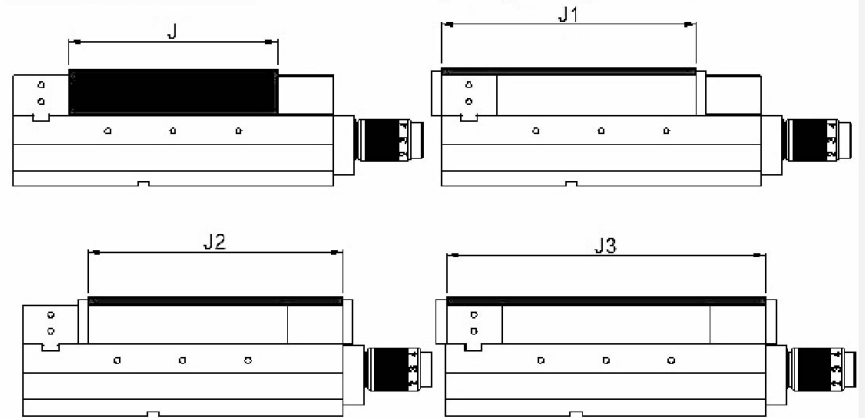
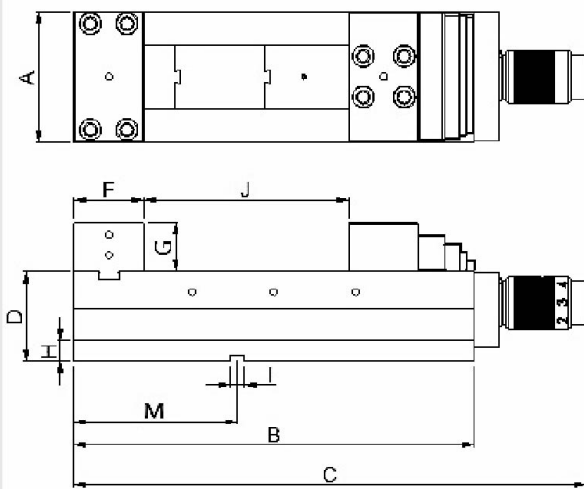

MODEL	A	B	C	D	F	G	H	I	M	J	J ₁	J ₂	J ₃	Clamping Force (kgf)	Weight (Kg)
AFPV-100	100	310	442	85	75	50	25	18	110	150	210	210	300	3,500	30
AFPV-130	130	410	542	100	80	55	25	18	135	240	300	300	400	4,500	45
AFPV-160	160	490	622	110	85	60	25	18	200	300	380	380	480	5,000	64
AFPV-160L	160	550	682	110	85	60	25	18	200	360	440	440	540	5,000	69
AFPV-200	200	530	662	110	85	60	25	18	220	350	420	420	520	5,500	86

FEATURES

- ▶ Standard Accessories :
1.Ratchet Handle x1 pc 2.Guide Key x2 pcs 3.Screw M6x12L x2 pcs 4.Locked Block x4 pcs
- ▶ Optional Accessories : vise jaws

- Machine vise is processed and ground with precision in various ways, suitable for precision machining in vertical/horizontal integrated milling and cutting machine centers.
- The main body of the vise is made of high ductility nodular cast iron (FCD600) with integrated molding design. The sliding surfaces undergo harden heat treatment (HRC50°) to ensure high precision, high wear resistance, and high tensile strength.
- Both fixed block and sliding block are made of steel and heat treatment to a hardness of over HRC50°, providing high hardness and wear resistance. Users can add or replace different sizes of jaw plates according to machining requirements.
- This machine vise can be used in four different clamping modes.
- Unique segmented pressurization mechanism design (patented design), adjustable to four stages of pressurization force, enabling optimal pressure adjustment for different workpieces or processing methods, featuring by rapid pressurization and high clamping force (up to 5,500kgf)
- This machine vise features a chipsproof design, which prevents iron chips from entering the interior of the vise, thus extending its lifespan.
- The height (D) of the vise is fixed, allowing for multiple units to be used in parallel.



CNC PRECISION MACHINE VISE MFV



Four clamping ways for choice

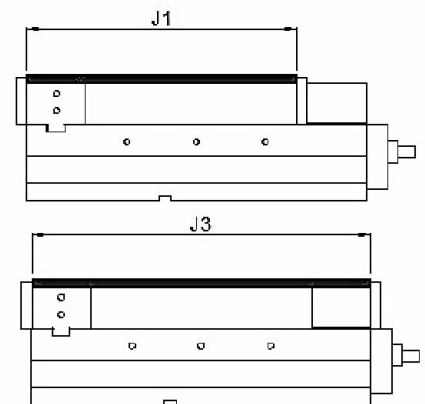
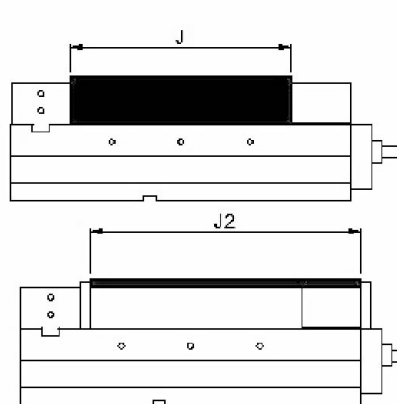
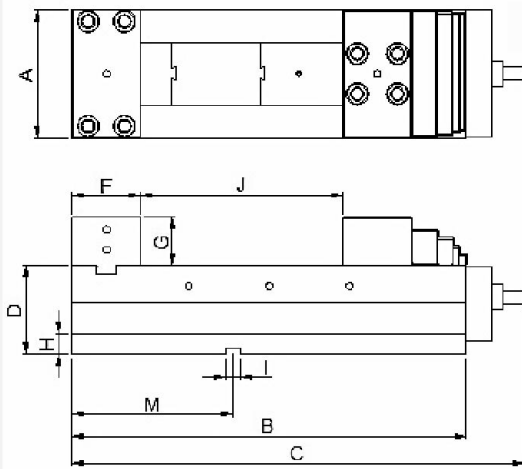

MODEL	A	B	C	D	F	G	H	I	M	J	J ₁	J ₂	J ₃	Weight (Kg)
MFV -100	100	310	400	85	75	50	25	18	110	150	210	210	300	29
MFV -130	130	410	500	100	80	55	25	18	135	240	300	300	400	44
MFV -160	160	490	580	110	85	60	25	18	200	300	380	380	480	63
MFV-160L	160	550	640	110	85	60	25	18	200	360	440	440	540	68
MFV -200	200	530	620	110	85	60	25	18	220	350	420	420	520	85

FEATURES

► Standard Accessories :

1.Ratchet Handle x1 pc 2.Guide Key x2 pcs 3.Screw M6x12L x2 pcs 4.Locked Block x4 pcs

► Optional Accessories : vise jaws

- Machine vise is processed and ground with precision in various ways, suitable for precision machining in vertical/horizontal integrated milling and cutting machine centers.
- The main body of the vise is made of high ductility nodular cast iron (FCD600) with integrated molding design. The sliding surfaces undergo harden heat treatment (HRC50°) to ensure high precision, high wear resistance, and high tensile strength.
- Both fixed block and sliding block are made of steel and heat treatment to a hardness of over HRC50°, providing high hardness and wear resistance. Users can add or replace different sizes of jaw plates according to machining requirements.
- This machine vise can be used in four different clamping modes.
- This machine vise features a chipsproof design, which prevents iron chips from entering the interior of the vise, thus extending its lifespan.
- The height (D) of the vise is fixed, allowing for multiple units to be used in parallel.



MC POWER MACHINE VISE EXTENDED MECHANICAL TYPE MPPV-D

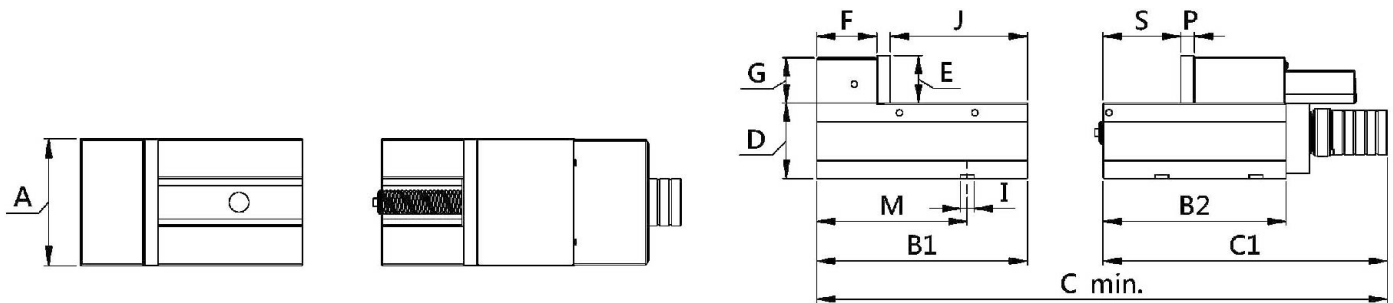

MODEL	A	B1	B2	C	C1	D	E	F	G	H	I	J	M	P	S	Clamping Force (kgf)	Weight (Kg)
MPPV-100D	100	173	200	510	335	85	53	60	50	25	18	98	110	15	80	3,500	27
MPPV-130D	130	228	220	585	355	100	58	75	55	25	18	138	160	15	90	4,500	43
MPPV-160D	160	280	243	660	378	110	63	80	60	25	18	182	200	18	100	5,000	61
MPPV-200D	200	324	269	720	404	110	63	95	60	25	18	211	220	18	120	5,500	83

Standard Accessories :

1.Ratchet Handle x1pc 2.Guide Key x2 pcs 3.Screw M6x12L x2 pcs 4.Locked Block x4 pcs

FEATURES

- This machine vise undergoes precision machining and grinding processes, it can be adjusted the clamping length according to the length of the workpiece being machined.
- The main body of the vise is made of high ductility nodular cast iron (FCD600) with integrated molding design. The sliding surfaces undergo harden heat treatment (HRC50°) to ensure high precision, high wear resistance, and high tensile strength.
- The hardness of the jaw plates after heat treatment is HRC55°.
- The semi-spherical ball can generate angular locking force, which can eliminate workpiece lifting.
- Unique mechanical pressurization mechanism design (patented design), featuring rapid pressurization and high clamping force (max to 5,500kgf).
- The height (D) of the vise is fixed, allowing for multiple units to be used in parallel.



MC DOUBLE LOCK & ANGLOCK MACHINE VISE DPV

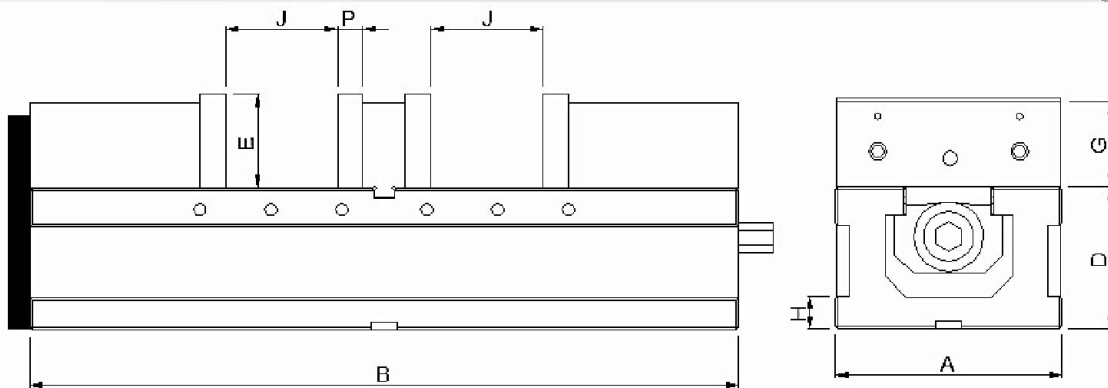

MODEL	A	B	D	E	G	H	P	J	Weight (Kg)
DPV-100	100	400	85	53	50	25	15	50	27
DPV-160	160	500	100	63	60	23	18	70	64

- Standard Accessories :
- 1.Ratchet Handle x1 pc
 - 2.Guide Key x2 pcs
 - 3.Screw M6x12L x2 pcs
 - 4.Locked Block x4 pcs

Five clamping ways for choice

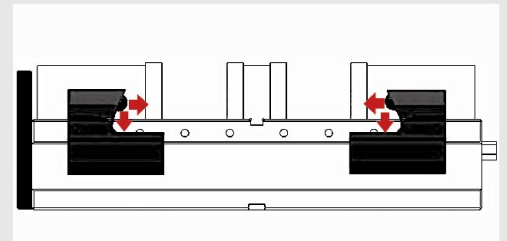

FEATURES

- Dual clamping mechanism, one side can be freely adjusted within the opening range, allowing simultaneous machining of two different-sized workpieces.
- When machining larger workpieces where the original opening is insufficient for clamping, the middle jaw can be removed to increase the clamping distance.
- The main body of the vise is made of high ductility nodular cast iron (FCD600) with integrated molding design. The sliding surfaces undergo harden heat treatment (HRC50°) to ensure high precision, high wear resistance, and high tensile strength.
- The semi-spherical ball can generate angular locking force, which can eliminate workpiece lifting.
- This machine vise can be used in five different clamping modes.
- This machine vise features a chipsproof design, which prevents iron chips from entering the interior of the vise and easy discharge of chips, thus extending its lifespan.
- The height (D) of the vise is fixed, allowing for multiple units to be used in parallel.



SEPARATE PRECISION MACHINE VISE SPPV-160

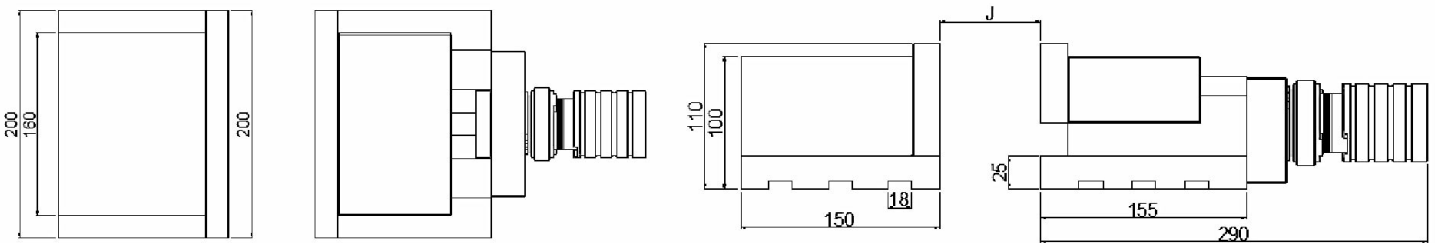
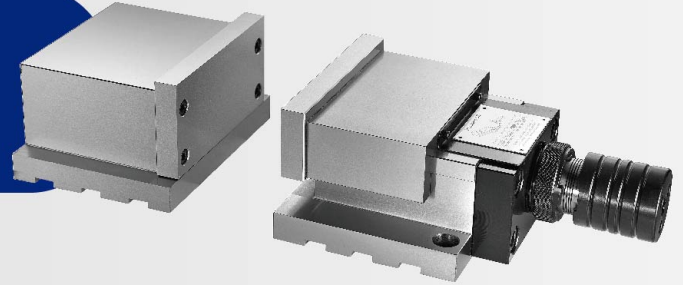

MODEL	J	Clamping Force (kgf)	Stroke (mm)
SPPV-160	Adjustable opening based on workpiece	3,500	30

- Standard Accessories :
- 1.Ratchet Handle x1pc
 - 2.Locked Block x 8 pcs
 - 3.Guide Key x 2 pcs
 - 4.Screw M6x12L x 2 pcs

FEATURES

- The workpiece can be placed directly on the worktable, which enhances the stability of the machining process.
- Clamping large workpieces, or adjusting the clamping position based on the size of the workpiece.
- The semi-spherical ball can generate angular locking force, which can eliminate workpiece lifting.
- The biggest difference compared to other separable type of machine vise is the ability to place the workpiece directly on the worktable, increasing clamping stability.
- The main body of the vise is made of high ductility nodular cast iron (FCD600) with integrated molding design. The sliding surfaces undergo harden heat treatment (HRC50°) to ensure high precision, high wear resistance, and high tensile strength.
- The hardness of the jaw plates after heat treatment is HRC55°.



MC PRECISION SUPER HI-PRESSURE RAPID VISE TPV

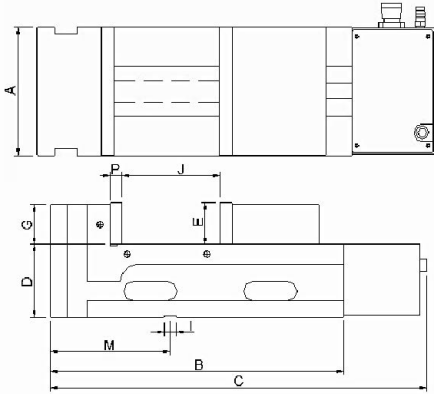

The front output can generate dual side force, reducing body deformation for more precise workpieces.

The semi-spherical ball can generate downward locking force, eliminating floating on the jaw plates and workpiece tilting.



MODEL	A	B	C	D	E	G	I	M	P	J	Clamping Force (kgf)	Weight (Kg)
TPV-4"-100	100	320	435	100	48	45	16	145	15	100	3,200	29
TPV-5"-150	130	380	505	105	55	52	18	145	15	150	6,000	40
TPV-6"-160	160	400	525	105	58	55	18	145	15	160	6,000	50
TPV-6"-250	160	490	615	105	58	55	18	145	15	250	6,000	55
TPV-7"-200	180	460	585	110	63	60	18	180	18	200	9,000	72
TPV-8"-200	200	470	595	110	63	60	18	180	18	200	9,000	80
TPV-8"-300	200	570	695	110	63	60	18	180	18	300	9,000	90

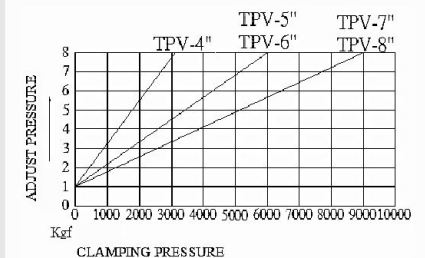

FEATURES

Standard Accessories :

1.Handle x 1 pc 2.Guide Key x 2 pcs 3.Screw M6x10L x 2 pcs 4.Locked Block x 4 pcs

- **Quick clamping and releasing:** The principle of this machine vise is to use a reciprocating pneumatic motor, which utilizes continuous air pressure to drive the hydraulic system to achieve automation.
- **Ultra-high clamping force:** With a low-pressure air supply of 8 kg/cm², it can achieve an ultra-high gripping force of 9,000 kgf.
- **Automatically seek the highest air pressure source:** When processing lightweight copper or aluminum products or heavy cutting of cast iron billets, set the regulator to the required pressure. This ensures that there is no pressure loss due to the air pressure being at a low point, and it also has automatic pressure compensation and stabilization functions to ensure the workpiece is securely gripped.
- **User-friendly design:** The machine vise is controlled with a manual switch, enabling a switch speed of just 1.5 seconds. The safe clamping distance is 8mm, preventing any risk of injury during operation. Additionally, it can be integrated into automated unmanned production systems for special designs (compatible with electronic control valves or controlled via machine controllers).
- **Triple-function (vertical, lateral, horizontal):** The machine vise has fixed dimensions and its body is polished on all six sides with a reserved pressure plate groove, allowing for machining without the need for a fixture board, enabling upright machining.
- **Ultra-high quality material:** The body of the machine vise is made of high ductility spherical graphite cast iron (FCD600) with an integrated design, and the two sides of the slide rails undergo hardening heat treatment (HRC45 °), ensuring high precision, high wear resistance, and high tensile strength.
- **Internal angular locking pressure structure:** The semi-spherical ball can generate downward locking force, eliminating floating on the jaw plates and workpiece tilting.



MC SUPER HI-PRESSURE DOUBLE VISE DPV-6-100

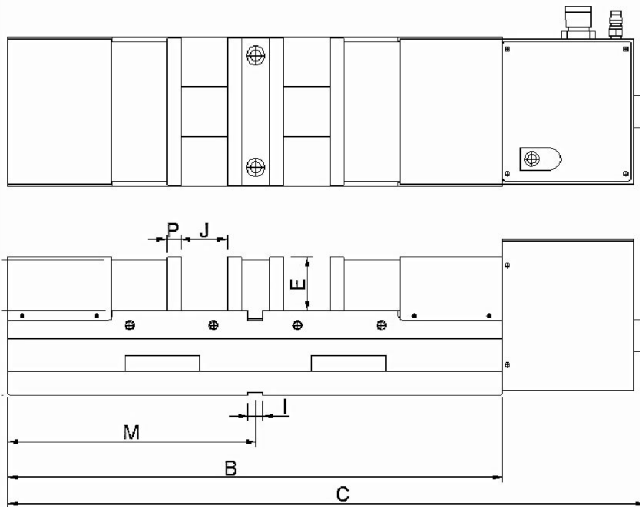
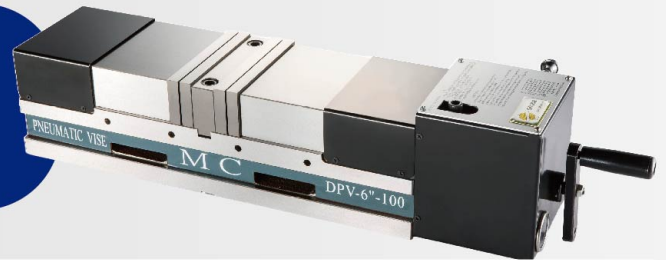

The semi-spherical ball can generate downward locking force, eliminating floating on the jaw plates and workpiece tilting.

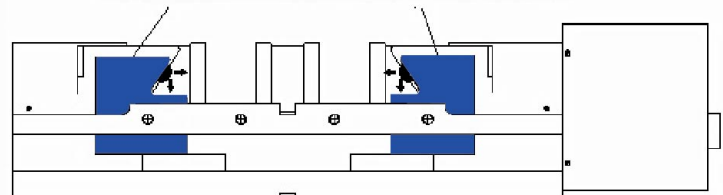

MODEL	A	B	C	D	E	G	I	M	P	J	Clamping Force (kgf)	Weight (Kg)
DPV-6"-100	160	530	680	90	58	55	18	265	15	100	4,000	66

- Standard Accessories :
- 1.Handle x 1 pc
 - 2.Guide Key x 2 pcs
 - 3.Screw M6x10L x 2 pcs
 - 4.Locked Block x 4 pcs

FEATURES

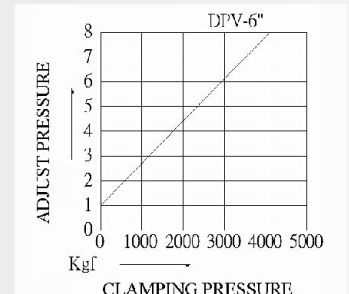

- Double clamping structure : Clamping two workpieces simultaneously, increasing productivity, so that the original function of holding more rapid upgrade.
- Quick clamping and releasing: The principle of this machine vise is to use a reciprocating pneumatic motor, which utilizes continuous air pressure to drive the hydraulic system to achieve automation.
- Ultra-high clamping force: With a low-pressure air supply of 8kg/cm², it can achieve an ultra-high gripping force of 4,000 kgf.
- Automatically seek the highest air pressure source: When processing lightweight copper or aluminum products or heavy cutting of cast iron billets, set the regulator to the required pressure. This ensures that there is no pressure loss due to the air pressure being at a low point, and it also has automatic pressure compensation and stabilization functions to ensure the workpiece is securely gripped.
- User-friendly design: The machine vise is controlled with a manual switch, enabling a switch speed of just 1.5 seconds. The safe clamping distance is 5mm, preventing any risk of injury during operation. Additionally, it can be integrated into automated unmanned production systems for special designs (compatible with electronic control valves or controlled via machine controllers).
- Ultra-high quality material: The body of the machine vise is made of high ductility spherical graphite cast iron (FCD600) with an integrated design, and the two sides of the slide rails undergo hardening heat treatment (HRC45°), ensuring high precision, high wear resistance, and high tensile strength.
- Internal angular locking pressure structure: The semi-spherical ball can generate downward locking force, eliminating floating on the jaw plates and workpiece tilting.



AIR POWER VISE APV-160

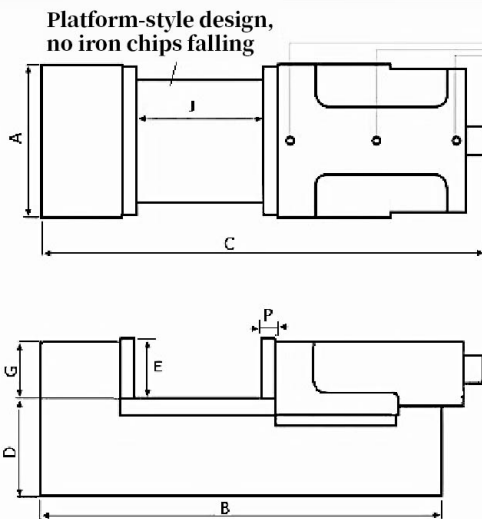

Oil injection hole

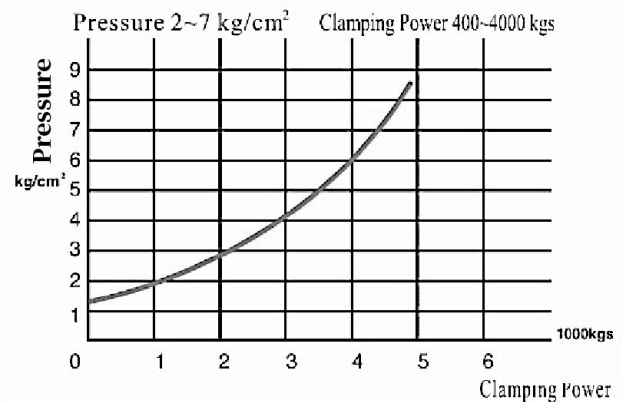

MODEL	A	B	C	D	E	G	P	J	Clamping Force (kgf)	Weight (Kg)
APV-160	160	480	685	85	60	60	15	210	400~4,000	60

► Standard Accessories : 1. Handle x 1 pc 2. Screw 5/8" x 4 pcs 3. Vise locked block x 3 pcs

FEATURES

- Quick clamping and installation of check valves, ensuring that even if the air duct breaks, pressure loss is prevented, resulting in high safety.
- Special fivefold pressurization cylinder + lever pressurization design.
- The work surface adopts a platform-style design, without gaps or iron chips falling, making it convenient for placing workpieces.
- The sliding surface undergoes heat treatment with a hardness of HRC 50 or higher, ensuring high precision through rigorous grinding, making it sturdy and durable.
- The entire machine vise is made of FCD 65 kg/cm² nodular cast iron, offering high rigidity with no deformation or damage.
- Clamping operation takes only 0.5 seconds.



5-AXIS AIR VISE PSC

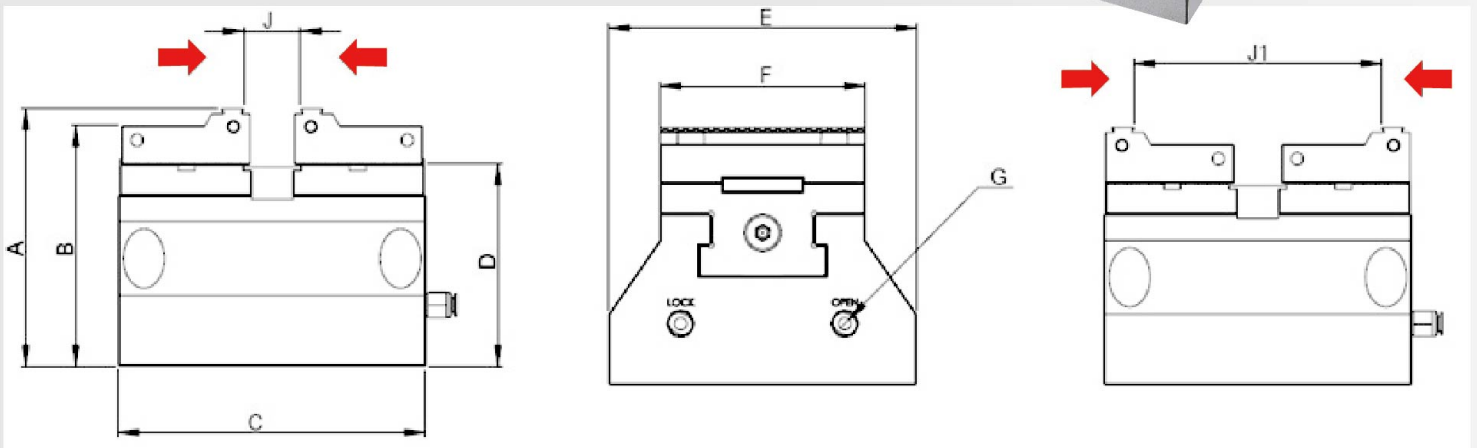

MODEL	A	B	C	D	E	F	G	J	J1	Open stroke	Max-Clamping Force(lbf)	N.W. KG
PSC-100	124	116	150	100	150	100	Ø8	27.5	120	4	2,750	25
PSC-88	111.5	103.5	150	88	150	100	Ø8	27.5	120	3	2,400	23.5

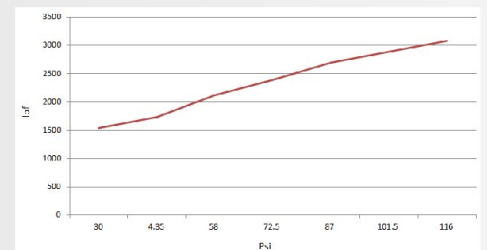

► Standard Accessories : 1.T-slot Nut (M12) x 4 pcs 2.Screw M12x30L x 4 pcs

► Optional Accessories : 1.Adapter Board (for the heighten function, the hole can also be used to connect the air pressure pipe.)

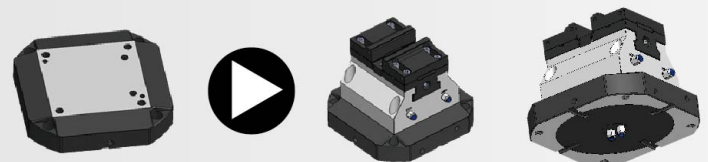
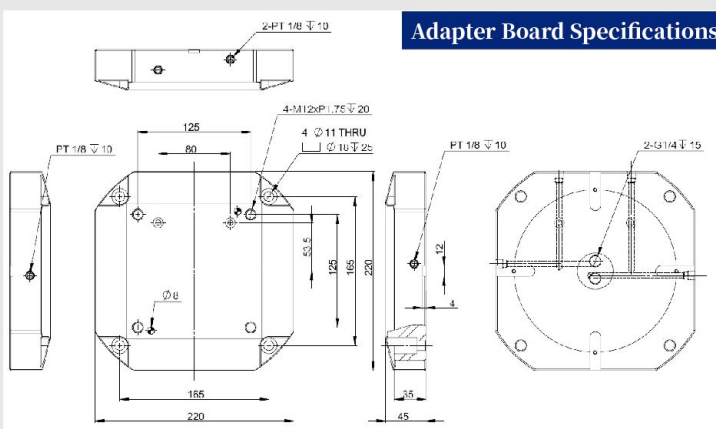

► Manual Control Optional Accessories : 1.Pressure Valve: UR – 02(G1/4) 2.Manual valve: Four-port three-position (G1/4)

► Automatic Control Optional Accessories :

1.Pressure Valve: UR – 02(G1/4牙) 2.Solenoid Valve (Five-port two-position / Five-port three-position) 3.Quick Coupling (PC 08 – 02_PT1/4)



Can change the direction of the sliding block to increase the clamping distance

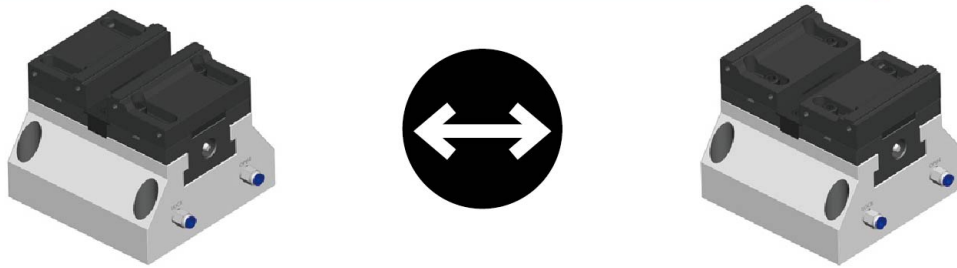

Flexible use of the sliding block to meet the clamping needs of different workpieces

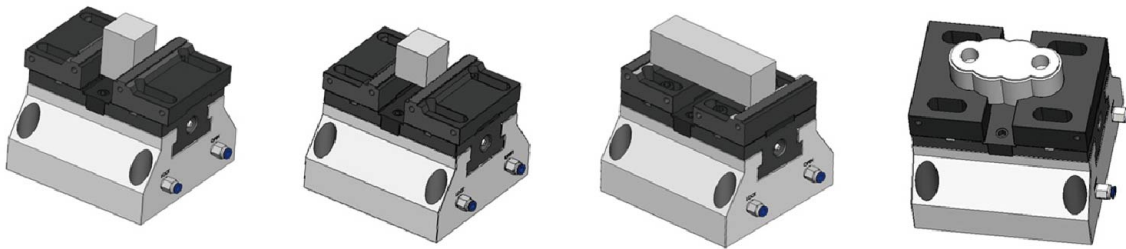

FEATURES

- Pneumatic self-centering vise, with high repeat clamping positioning accuracy (up to 0.01mm), suitable for precision machining applications in precision 4-axis or 5-axis CNC machine tools, rotary tables, or CNC machining centers
- Depending on the machining requirements, it can be operated manually with a switch for clamping or automatically with a switch. The clamping switch operates quickly and can also be integrated with machine tools and robotic arms for automated production.
- Special internal design prevents pressure loss due to low air pressure, ensuring the safety of workpiece clamping and processing.
- Pneumatic self-centering vise can be arranged in parallel with fixed height specifications for multiple units, allowing simultaneous use to significantly increase production efficiency and save costs.
- The body and parts of the machine vise are made of high-grade alloy steel and undergo a high-quality tempering and harden heat treatment process, providing characteristics of high strength, high wear resistance, and high tensile strength. They undergo precise machining and high-precision grinding, resulting in high clamping surface accuracy, achieving high-quality machining effects and meeting requirements.
- The hardness of the jaw plates after heat treatment is above HRC45°, enabling clamping of various high-hardness materials. The jaw plates can be quickly reoriented to increase the gripping distance or changed to different jaw forms to meet the clamping requirements of various workpieces, providing versatility and flexibility in workpiece clamping. The upper end of the jaw plates features a special structure with a 45° angled dovetail design, which generates downward clamping force and ensures secure clamping of the workpiece



ROTATING OIL SEPARATION SYSTEM

Use with UT-TECH pneumatic vise, different rotating oil separation system can be produced according to customer requirements.

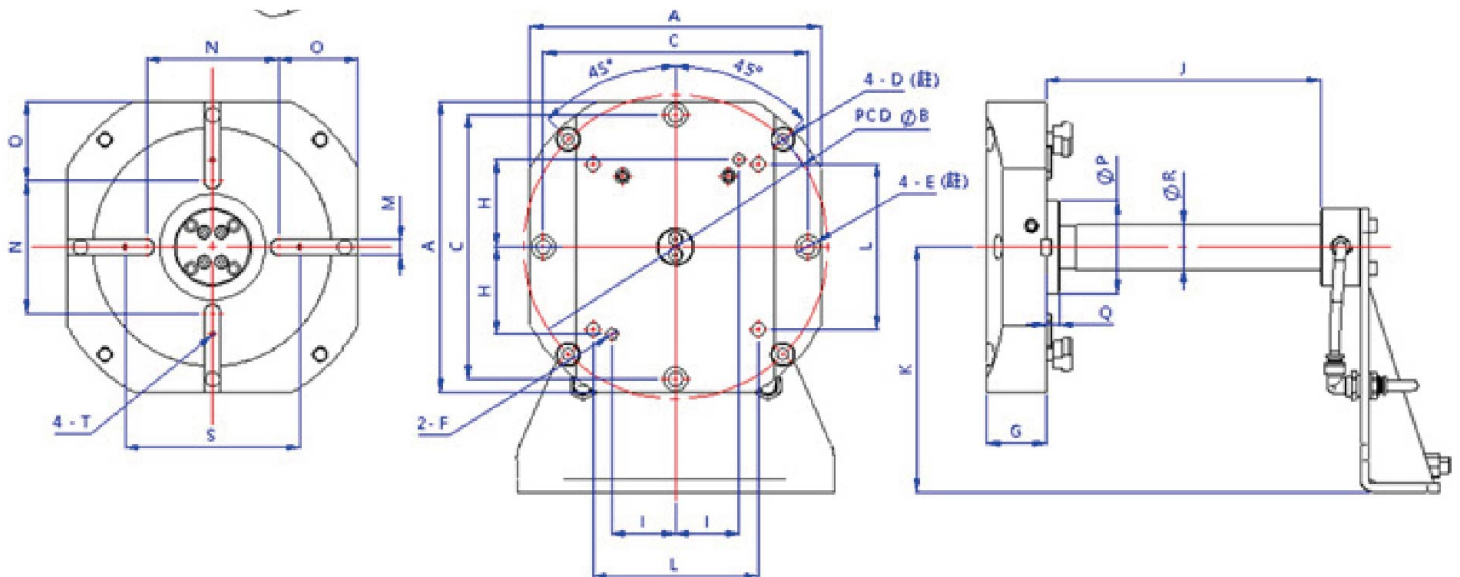
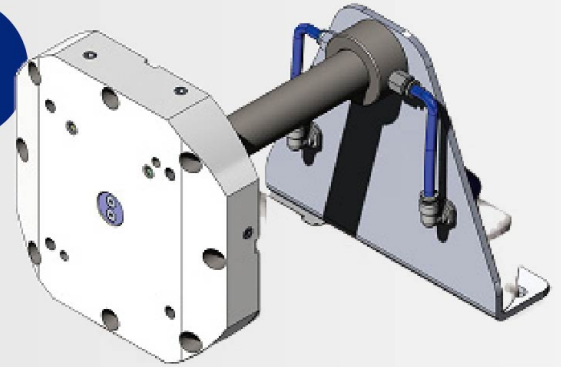

MODEL		A	PCD ØB	C	D	E	F	G	H	I
OOS-250		220	230	200	4 - M10	4 - M10	Ø8PIN	45	66	48
J	K	L	M	N	O	P	Q	R	S	T
Customized		125	12	100	60	Ø70	10	Ø 34	132	4 - M4

Note (D) and Note (E), please choose one of the fixed method.

Note (P) is the center positioning contact surface, which can be equipped with a positioning ring for use with the fourth-axis positioning hole.

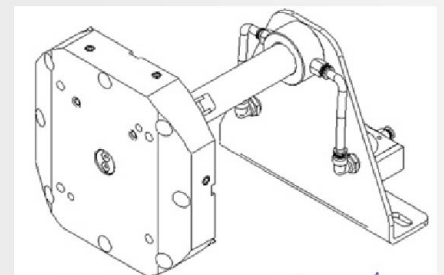

Standard Accessories :

- 1.T-SLOT (M10) x 4 PCS
- 2.SCREW M10 x 25L x 4 PCS
- 3.Customized oil supply bracket
- 4.Parallel key 12 x 30 x 4PCS
- 5.Screw M4 x 10L x 4 PCS
- 6.Quick Coupling PC801 x 2 PCS

Optional Accessories :

Center positioning ring (Material : medium-carbon steel).
This is used in conjunction with the fourth axis, with a center positioning ring, or it can be centered using a cross-key groove.



Diagram of the Rotary Oil Separation System with the fourth axis & PSC-100 pneumatic vise

Primarily paired with the fourth axis.

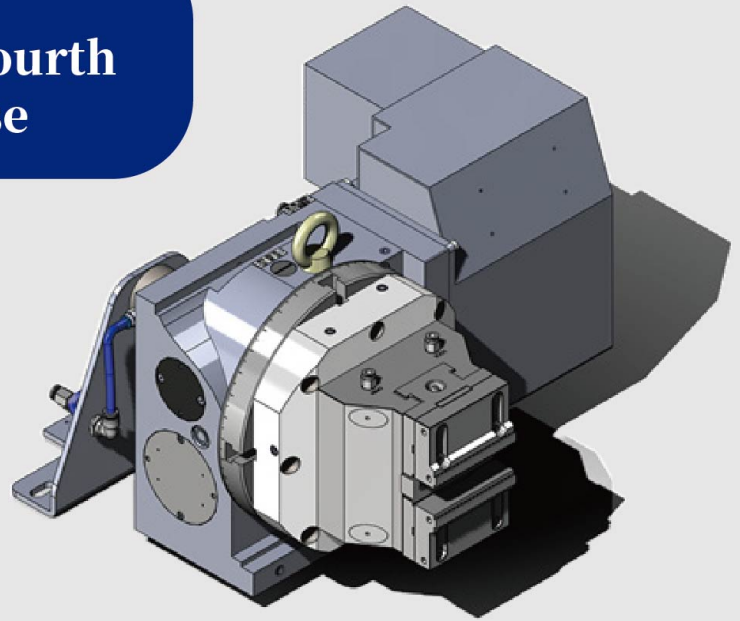

Operation Instruction

When installing the Rotary Oil Separation System, first pass the entire mechanism's axis through the center hole of the fourth axis, aligning the key groove (or center positioning ring). Secure it with the T-slot nut, then lock the oil supply axis adapter plate onto the main shaft. Install the oil separation axis bracket and its air pipe. Lock PC801 quick coupling on both sides of the adapter plate. The PC801 quick coupling line can be connected to a manual valve or an automatic switch to form a clamping loop, allowing the mechanism to control gripping and releasing.

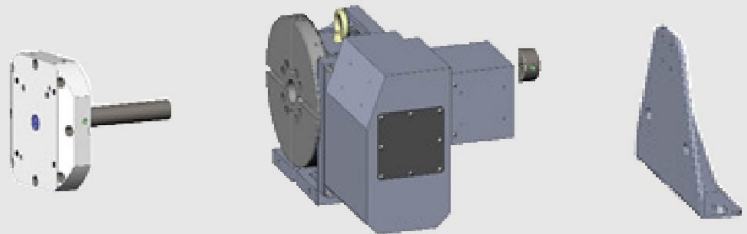

FEATURES

- This Rotary Oil Separation System serves as an intermediate connecting device between the pneumatic vise or mold fixture and the fourth axis. It provides pneumatic pressure for the pneumatic vise, ensuring its clamping function operates normally and synchronizes with the 360-degree rotation of the fourth axis worktable.
- Depending on processing needs, it can be used for manual or automatic clamping. The clamping switch operates quickly and can be mounted on machine tools or integrated with robotic arms for automated production.
- Unlike similar products on the market that require disassembling the pneumatic lines to control the clamping of the pneumatic vise, preventing a 360-degree rotation without removing the pneumatic lines, this oil separation system significantly saves loading and unloading time. It also improves the cumbersome process of disassembling pneumatic lines, thus saving time and labor costs.
- This Rotating Oil Separation System aligns with the current trend towards automated production. Besides enhancing production efficiency, it can be combined with robotic arms to achieve intelligent and automated manufacturing.



HYDRAULIC MACHINE VISE BUILT-IN TYPE HP

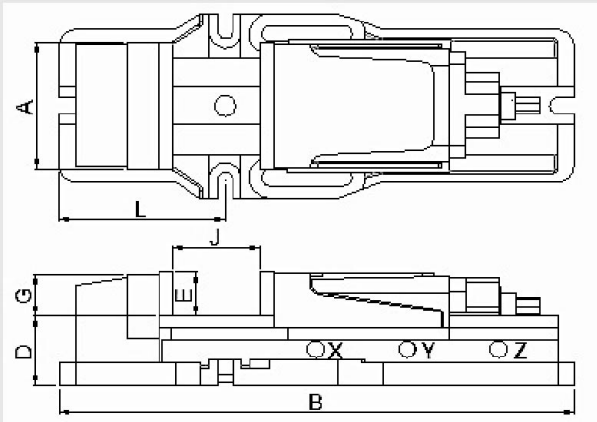

FEATURES

- New hydraulic cylinder with more stable clamping force, resistant to machine vibration, and featuring convenient disassembly and maintenance capabilities.
- Equipped with a large opening for clamping and quick movement forwards and backwards.
- This machine vise utilizes high-quality cast iron, and all sliding surfaces of the vise body are hardened, heat-treatment to HRC45° or higher, ensuring long-lasting wear resistance and precision.

MODEL	A	B	D	E	G	L	Opening Position J			Clamping Force (kgf)	Weight (Kg)
							X Position	Y Position	Z Position		
HP-4"	106	440	58	36	35	147	0-60	60-110	110-170	2,500	22
HP-5"	132	550	70.5	48	49.5	195	0-70	70-140	140-220	3,000	38
HP-6"	152	620	82.5	53	52.5	210	0-100	100-200	200-300	4,500	53
HP-8"	200	680	96	63	60	260	0-100	100-200	200-300	6,000	85

► Standard Accessories :
1.Handle x 1 pc 2.Sleeve x 1 pc
3.Connecting Rod x 1 pc

► Optional Accessories :
Swivel base x 1 set

Note: If need swivel base, the model will be HP-4-B, HP-5-B, HP-6-B, HP-8-B

MC HYDRAULIC ANGLE LOCK VISE - BUILT-IN TYPE CMHA

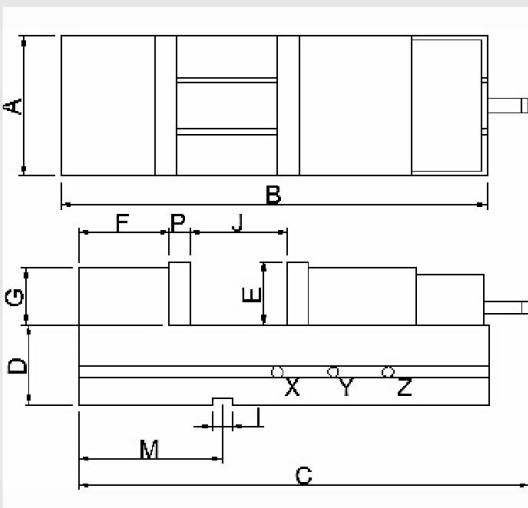
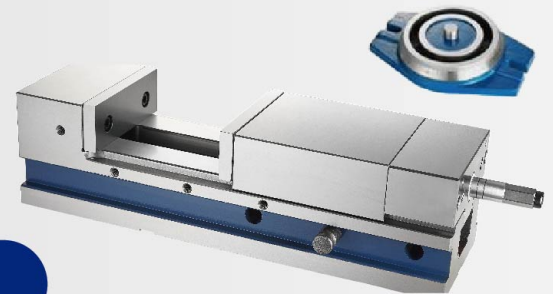

FEATURES

- This body of machine vise made of spherical graphite cast iron FCD600 material
- The semi-spherical ball can generate downward locking force, reducing the occurrence of workpiece floating.
- The machine vise can be placed sideways to use.
- The sliding surfaces of the vise are all subjected to hardened heat treatment to achieve HRC45°, ensuring durability and precision
- The sliding top cover of the vise is removable, making it convenient to remove iron chips from inside the vise.
- The height of vise body and groove of guide key are both made to fixed specifications, allowing multiple vises to be used together simultaneously.

MODEL	A	B	C	D	E	F	G	I	M	P	Opening Position J			Clamping Force (kgf)	Weight (Kg)
											X Position	Y Position	Z Position		
CMHA-100	105	404	540	62	42	64.5	40	16	122	12.5	0-85	85-170		2,500	22
CMHA-150	154	507	710	85	57	84.5	55	18	165	15.5	0-90	90-180	180-270	5,000	50
CMHA-200	200	606	755	95	62	89.5	67	18	190	18.5	0-100	100-200	200-300	7,000	80

► Standard Accessories :
Handle x 1 pc



HYDRAULIC MACHINE VISE - EXTERNAL TYPE PHV

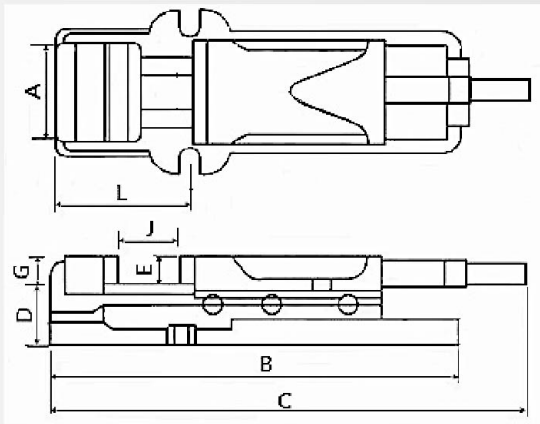

FEATURES

- Mechanical type / Hydraulic type can be used independently or in combination. Hydraulic clamping provides strong and stable force, suitable for heavy cutting and precision machining.
- Features a large opening for clamping and can move quickly back and forth.
- Made of high-quality cast iron, the sliding surfaces of machine vise undergo harden treatment, achieving a heat treatment of HRC45° or higher, ensuring long-lasting durability and precision

MODEL	A	B	C	D	E	G	L	J	Clamping Force (kgf)	Weight (Kg)
PHV-130	130	505	795	72	55	55	180	220	4,000	38
PHV-160	160	605	935	82	58	58	195	310	5,000	58
PHV-200	200	700	1035	100	63	63	265	310	6,000	95

► Standard Accessories :
1.Handle x 1 pc

► Optional Accessories :
Swivel base x 1 set



Note: If need swivel base, the model will be PHV-130-B, PHV-160-B, PHV-200-B

HYDRAULIC MACHINE VISE – TILTING TYPE HPT

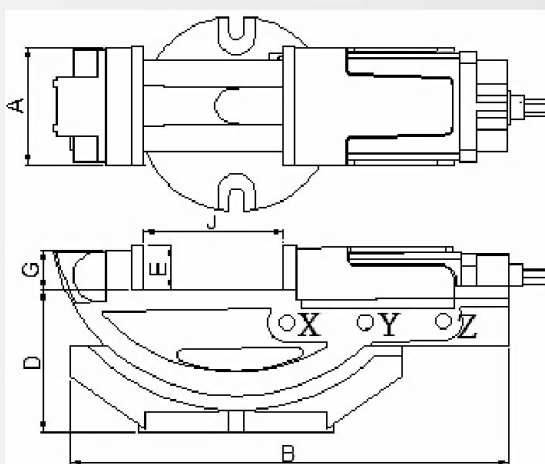
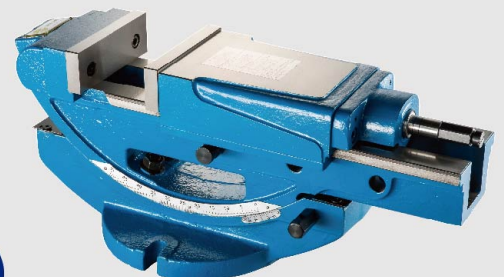

FEATURES

- This machine vise can be adjusted to different angles according to various needs. The vertical adjustment angle can be freely adjusted from 0° to 45° with precise degree markings, ensuring machining accuracy.
- New hydraulic cylinder with more stable clamping force, resistant to machine vibration, and featuring convenient disassembly and maintenance capabilities, belongs to the economical and durable type.
- Made of high-quality cast iron, and the sliding surfaces of the machine vise undergo harden treatment with a heat treatment of HRC45° or higher, ensuring long-lasting wear resistance and precision.

MODEL	A	B	D	E	G	Opening Position J			Clamping Force (kgf)	Weight (Kg)
						X Position	Y Position	Z Position		
HPT-4"	105	395	163	36	34	0-60	60-110	110-170	3,500	26
HPT-6"	150	560	250	53	52	0-100	100-200	200-300	4,500	71

► Standard Accessories :
1.Handle x 1 pc 2.Sleeve x 1 pc
3.Connecting Rod x 1 pc

► Optional Accessories :
Swivel base x 1 set



Note: If need swivel base, the model will be HPT-4-B, HPT-6-B



CNC PRECISION ANGLE LOCK VISE

SAV-160A (Max Opening can reach 8 inch)

SAV-160L (Max Opening can reach 9 inch)

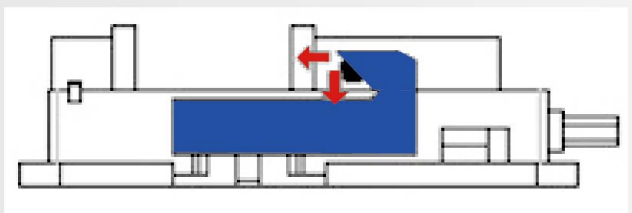
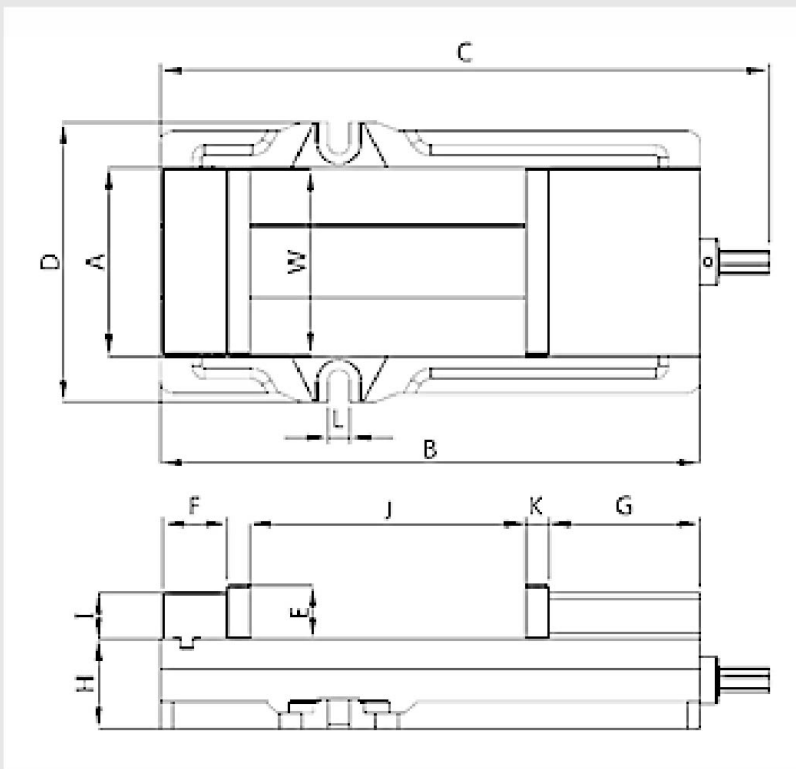
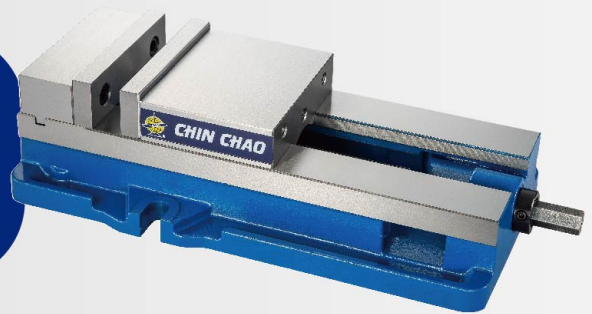

****Max Opening can reach**
SAV-160A/8 inch SAV-160L/9 inch

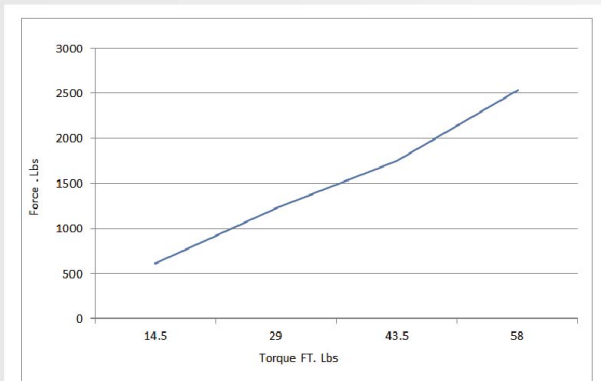

MODEL	A	B	C	D	E	F	G	H	I	J	K	L	W	Clamping Force(MAX)	Weight (KG)
SAV-160A	154	438	494	230	44.5	52	123	73	38	225	18	18	152	2,500,kgf	35 kgs
SAV-160L	154	438	494	230	44.5	52	114	73	38	230	18	18	152	2,500,kgf	34.5 kgs

► Standard Accessories : Handle x1pc

FEATURES

- The main body material is high-quality nodular cast iron FCD60, with good ductility and not easily deformed.
- After high-precision grinding treatment, the vise exhibits excellent accuracy and can be used in parallel. With a large opening design, it with a maximum opening of SAV-160A/8 inches, SAV-160L/9 inches.
- The semi-spherical ball can generate downward locking force, reducing the occurrence of workpiece floating.
- The sliding surface of the vise are all subjected to harden treatment, with a heat treatment of above HRC50°, ensuring long-lasting wear resistance and accuracy.
- The height (H) of the vise is fixed, allowing for multiple units to be used in parallel.



ANGLE LOCK MACHINE VISE SAV



FEATURES

- Simple in structure, it belongs to the economical and durable type of machine vise.
- The semi-spherical ball can generate downward locking force, reducing the occurrence of workpiece floating.
- Made of high-quality cast iron, the sliding surfaces of machine vise undergo harden treatment with a heat treatment hardness of HRC45° or higher, ensuring long-lasting wear resistance and precision.

▶ Standard Accessories :
Handle x1 set

▶ Optional Accessories :
Swivel base x 1 set

Note: If need swivel base, the model will be SAV-4-B, SAV-5-B, SAV-6-B, SAV-6-1/2-B, SAV-8-B

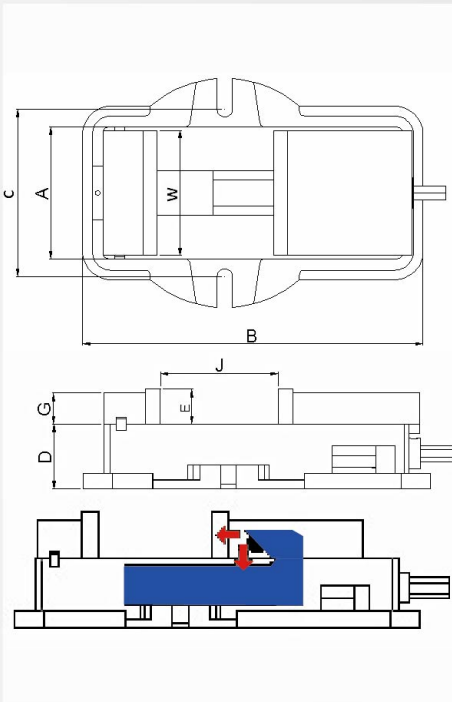

MODEL	A	B	D	E	G	W	J	Clamping Force(MAX)	Weight (KG)
SAV-4"	106	320	60	36	28	102	100	1,800kgf	15
SAV-5"	136	353	66	36	32	132	110	2,000kgf	23
SAV-6"	152	416	72	48	40	152	150	2,500kgf	31
SAV-6-1/2"	154	448	68	50	38	152	200	2,500kgf	33
SAV-8"	200	553	85	60	52	202	200	3,000kgf	59

ANGLE LOCK MACHINE VISE MC



FEATURES

- This product has undergone six-sided grinding, ensuring high precision. It can be flat or sideways placement, offering better functionality compared to traditional angle lock vise.
- The semi-spherical ball can generate downward locking force, reducing the occurrence of workpiece floating.
- Made of high-quality cast iron, the sliding surfaces of machine vise undergo harden treatment with a heat treatment hardness of HRC45° or higher, ensuring long-lasting wear resistance and precision.

▶ Standard Accessories :
Handle x 1 set

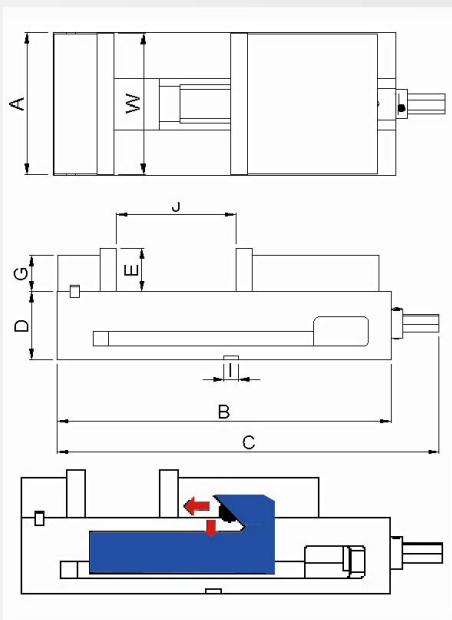

MODEL	A	B	C	D	E	G	I	W	J	Clamping Force(MAX)	Weight (KG)
MC-4"	106	280	324	58	36	28	16	102	100	1,800kgf	13
MC-5"	134	310	357	64	36	32	16	132	100	2,000kgf	19
MC-6"	153	368	424	75	48	40	16	152	150	2,500kgf	30
MC-8"	204	493	551	82	60	52	16	202	200	3,000kgf	62



PRECISION ANGLE LOCK MACHINE VISE SMC-6

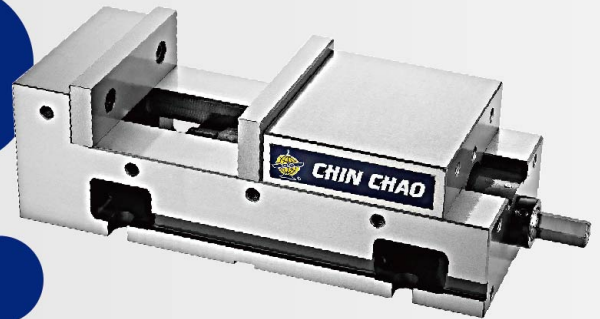
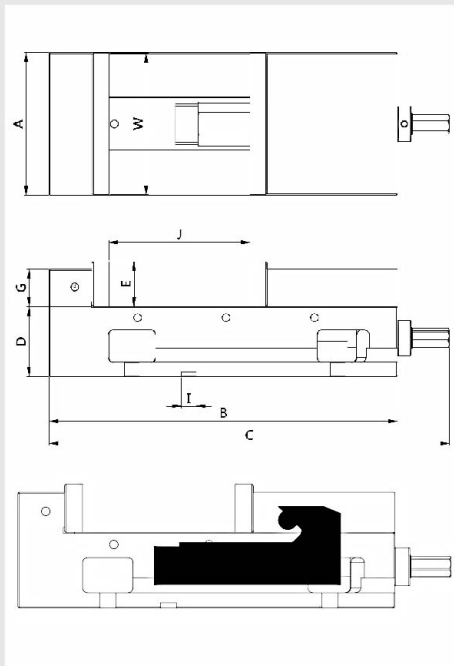

FEATURES

- This product has undergone six-sided grinding, ensuring high precision. It can be flat or sideways placement (usable in both vertical and horizontal positions), offering better functionality compared to traditional angle lock vise.
- The semi-spherical ball can generate downward locking force, reducing the occurrence of workpiece floating.
- Made of high-quality cast iron, the sliding surfaces of machine vise undergo harden treatment with a heat treatment hardness of HRC45° or higher, ensuring long-lasting wear resistance and precision.

MODEL	A	B	C	D	E	G	I	J	W	Clamping Force(MAX)	Weight (KG)
SMC-6"	153	374	430	75	48	40	16	152	152	2,500kgf	32

► Standard Accessories : Handle x 1 set

EXTENDED ANGLE LOCK MACHINE VISE XL

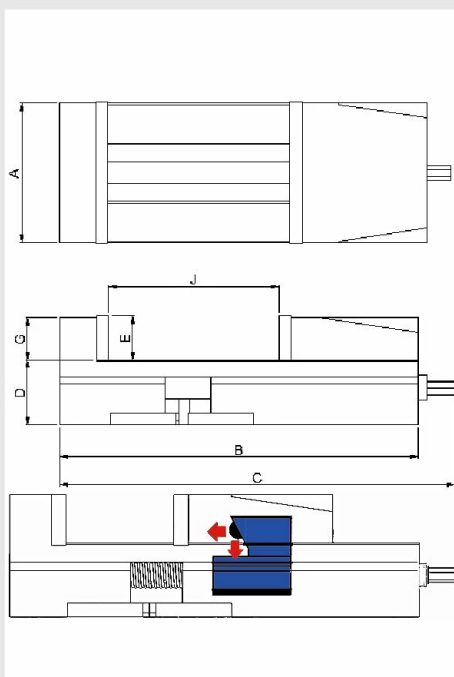

FEATURES

- This machine vise features a large opening for clamping, and the vise body is processed in one-piece molding to reduce assembly tolerances and deformation. Additionally, the vise body structure is more robust.
- The semi-spherical ball can generate downward locking force, reducing the occurrence of workpiece floating. Simple in structure, it belongs to the economical and durable type of machine vise.
- Made of high-quality cast iron, the sliding surfaces of machine vise undergo harden treatment with a heat treatment hardness of HRC45° or higher, ensuring long-lasting wear resistance and precision.

► Standard Accessories : Handle x1 set

► Optional Accessories : Swivel base x 1 set



MODEL	A	B	C	D	E	G	J	Weight (KG)
XL-8"	200	510	560	92	63	60	260	72

Note: If need swivel base, the model will be XL-8-B



K-TYPE MILLING VISE SKV-K

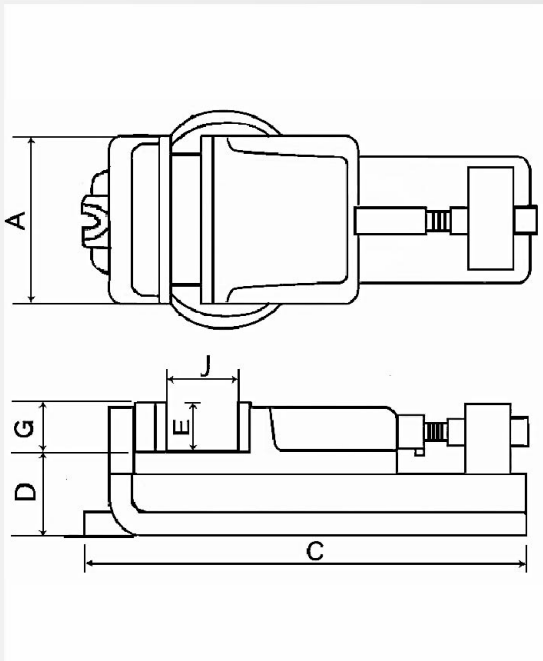

FEATURES

- Simple in structure, it belongs to the economical and durable type of machine vise.
- Made of high-quality cast iron, the sliding surfaces of machine vise undergo harden treatment with a heat treatment hardness of HRC45° or higher, ensuring long-lasting wear resistance and precision.

► Standard Accessories :
Handle x1 set

► Optional Accessories :
Swivel base x 1 set

Note: If need swivel base,
the model will be SKV-4-B,
SKV-5-B, SKV-6-B, SKV-8-B

MODEL	A	C	D	E	G	J	Weight (KG)
SKV-4"	97	294	48	34	32	60	10
SKV-5"	125	368	60	36	34	80	16
SKV-6"	150	460	65	43	43	110	27
SKV-8"	200	620	85	63	60	150	58

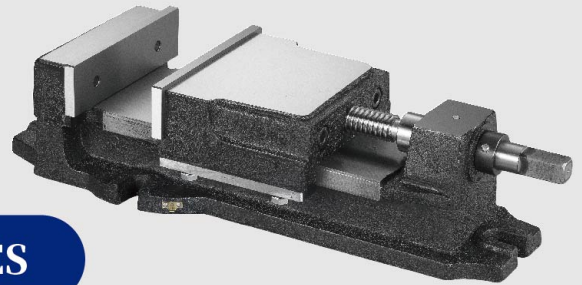

K - TYPE SUPER OPEN MILLING VISE J

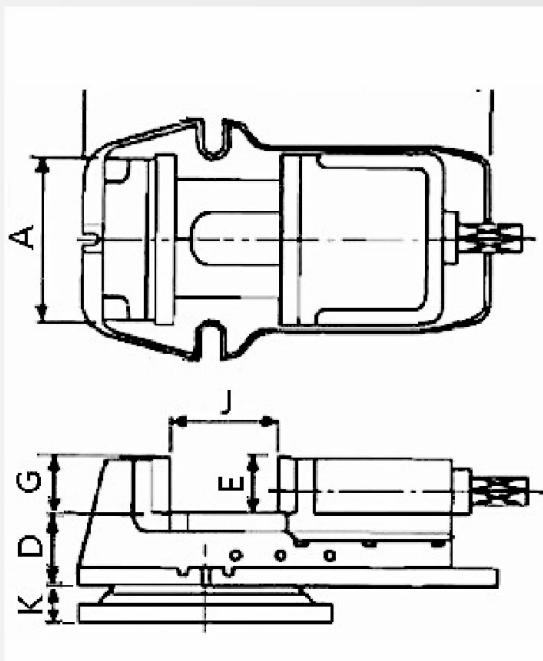

FEATURES

- This machine vise features a large opening for gripping, has a simple structure, and belongs to the economical and durable type of machine vise.
- Made of high-quality cast iron, the sliding surfaces of machine vise undergo harden treatment with a heat treatment hardness of HRC45° or higher, ensuring long-lasting wear resistance and precision.

► Standard Accessories :
Handle x1 set

► Optional Accessories :
Swivel base x 1 set

Note: If need swivel base,
the model will be SKV-4-B,
SKV-5-B, SKV-6-B, SKV-8-B

MODEL	A	B	D	E	G	K	J	Weight (KG)
J-400	110	390	58	38	37	41	180	21
J-500	130	450	66	49	48	42	230	32
J-600	152	540	77	54	54	42	300	45

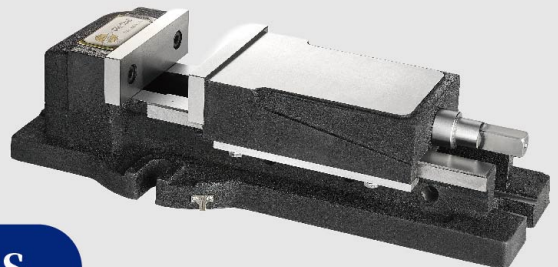



3-WAY ANGLE MILLING VISE CY

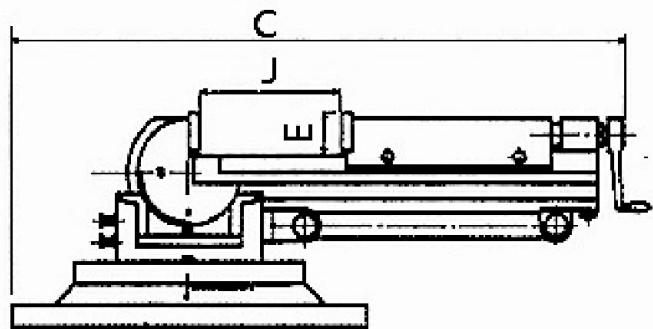
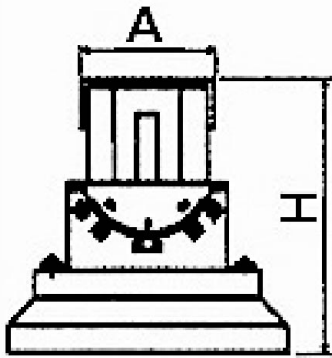
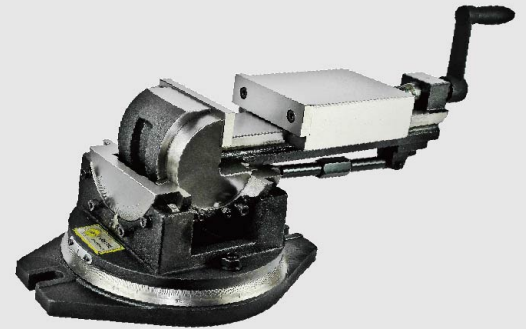

MODEL	A	C	E	H	J	Vertical Height	Weight (KG)
CY-3"	80	400	30	144	90	385	17
CY-4"	106	460	38	172	100	470	32
CY-5"	132	625	40	205	140	590	51

► Standard Accessories :
1.Handle x 1 set 2.Swivel base x 1 set

FEATURES

- The angle can be set in three different directions: it can rotate 360° horizontally; the vertical angle can be adjusted from 0° to 90°, and the tilting angle can be rotated left or right by 45°. The degree markings are precise to ensure machining accuracy.
- Maintains the workpiece stable and smooth at any tilted angle.
- Auxiliary support bars provide additional stability during workpiece processing.



WISE IN-ROW MRV-30080

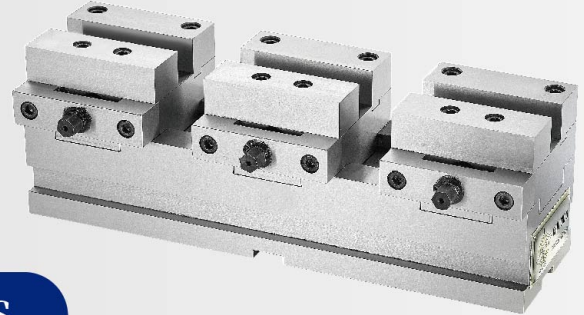

FEATURES

- Multi clamp machine vise, capable of simultaneously gripping multiple workpieces for processing.
- Made entirely of steel material, precision ground after heat treatment to ensure high precision and wear resistance of machine vise.
- Suitable for processing small workpieces.

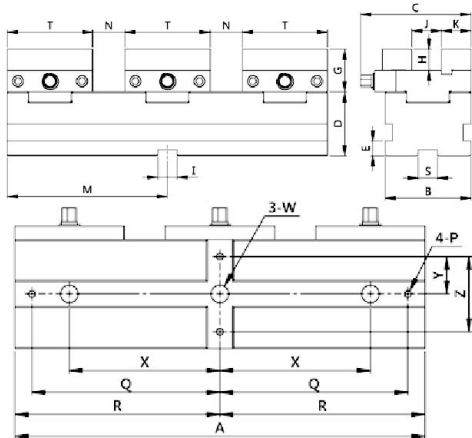

MODEL	A	B	C	D	E	G	H	I	J	K	M
MRV-30080	300	80	103	60	14	40	20	18	0~27.5	27	150
N	P	Q	R	S	T	W	X	Y	Z	NW.	GW.
30	M6	137.5	150	18	80	Ø13	110	27.5	55	16Kg	17Kg

OK-VICE SV



FEATURES

- The machine vise has undergone precise processing at each stage, making it suitable for precision machining applications.
- The vise body ensures high precision, high wear resistance, and high tensile strength.
- The machine vise can generate downward pressure when used, reducing the floating of the workpiece.
- Flexible feature allows for clamping various sizes of workpieces and can be used in parallel, enabling simultaneous processing of multiple items.

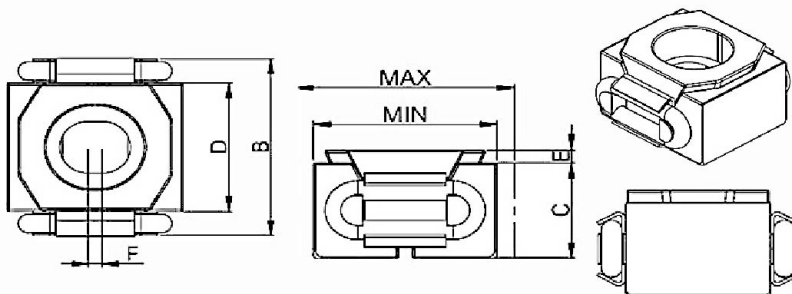

MODEL	Length (MIN)	Length (Suitable)	Length (MAX)	B	C	D	E	F	Applicable screws
SV-27	26	29	31	29	26	21	2.1	2	M8 x Ø20
SV-42	42	48	53	46	22	32	8.8	2	M12 x Ø30
SV-57	57	61	66	56.6	28.5	42	4	3	M16 x Ø40



PRECISION RAPID VISE CGT

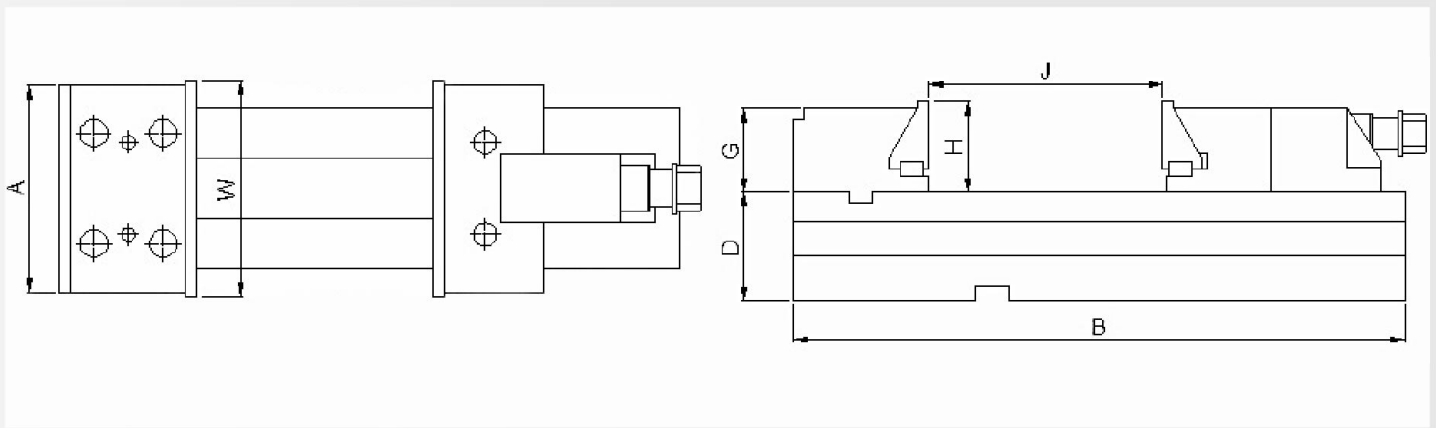
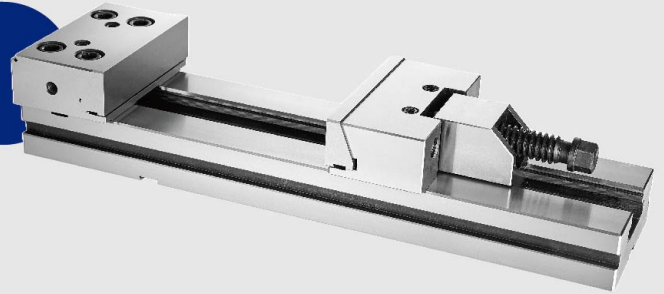

MODEL	A	B	D	G	H	W	J	Weight (KG)
CGT-100-100	100	270	35	30	30	100	100	12
CGT-125-150	125	345	40	40	40	125	150	19
CGT-150-200	150	420	50	50	50	150	200	34
CGT-150-300	150	520	50	50	50	150	300	38
CGT-175-300	175	555	58	60	60	175	300	57
CGT-200-300	200	595	70	65	65	200	300	90
CGT-200-500	200	795	70	65	65	200	500	104
CGT-300-300	300	635	75	80	80	300	300	120
CGT-300-500	300	835	75	80	80	300	500	160

► Standard Accessories :
 1.Handle x 1 pc 2.T-Wrench x 1 pc
 3.Lock Block x 3 pcs 4.Guide Key x 2 pcs

► Optional Accessories :
 Swivel base x 1 set



Note: If need swivel base, the model will be CGT-100-100B, CGT-125-150B, CGT-125-200B, CGT-150-300B, CGT-175-300B, CGT-200-300B, CGT-200-500B, CGT-300-300B, CGT-300-500B.

FEATURES

- Manufactured with alloy steel construction.
- The sliding surface hardness of the vise body is HRC58°~62°.
- Featuring interchangeable base, fixed jaw, and movable jaw, allowing for quick clamping and easy operation.
- Widely used in machining centers and other precision machine tools.



SPECIAL JAW PLATES FOR POWER MACHINE VISE

J1

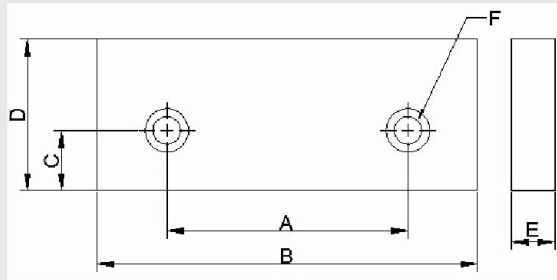
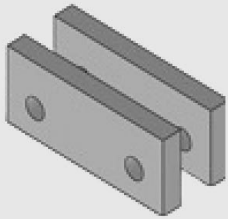

MODEL	A	B	C	D	E	F
J1-100	70	98	25	53	15	M10
J1-130	90	128	25	58	15	M10
J1-160	100	158	25	63	18	M10
J1-200	120	198	30	63	18	M12

J2

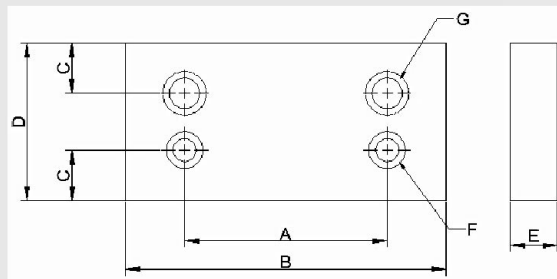
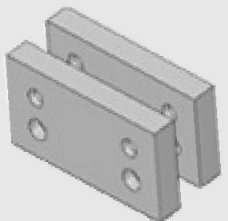

MODEL	A	B	C	D	E	F	G
J2-100	70	98	25	73	20	M10	M12
J2-130	90	128	25	73	20	M10	M12
J2-160	100	158	25	78	23	M10	M12
J2-200	120	198	30	85	23	M12	M14

J3

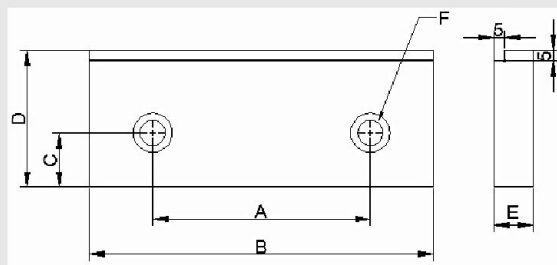
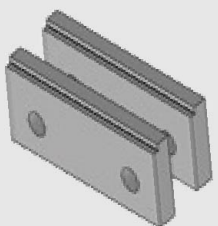

MODEL	A	B	C	D	E	F
J3-100	70	98	25	53	15	M10
J3-130	90	128	25	58	15	M10
J3-160	100	158	25	63	18	M10
J3-200	120	198	30	63	18	M12

J4

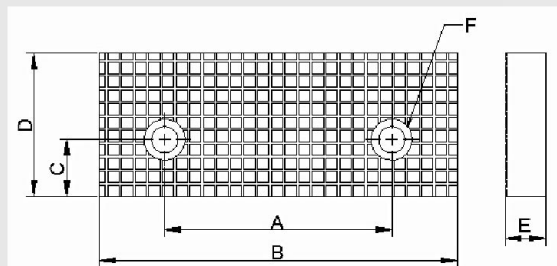
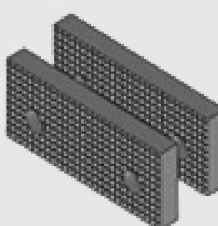

MODEL	A	B	C	D	E	F
J4-100	70	98	25	53	15	M10
J4-130	90	128	25	58	15	M10
J4-160	100	158	25	63	18	M10
J4-200	120	198	30	63	18	M12



J5

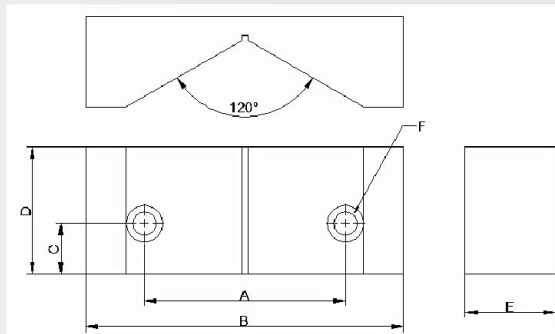
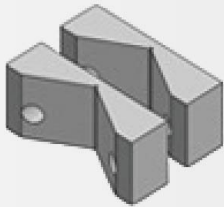

MODEL	A	B	C	D	E	F
J5-100	70	98	25	53	30	M10
J5-130	90	128	25	58	30	M10
J5-160	100	158	25	63	45	M10
J5-200	120	198	30	63	45	M12

J6

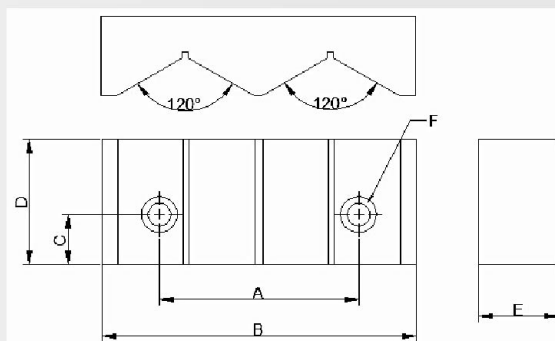
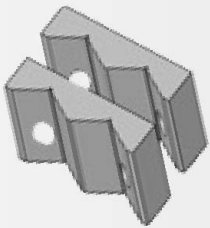

MODEL	A	B	C	D	E	F
J6-100	70	98	25	53	30	M10
J6-130	90	128	25	58	35	M10
J6-160	100	158	25	63	40	M10
J6-200	120	198	30	63	40	M12

J7

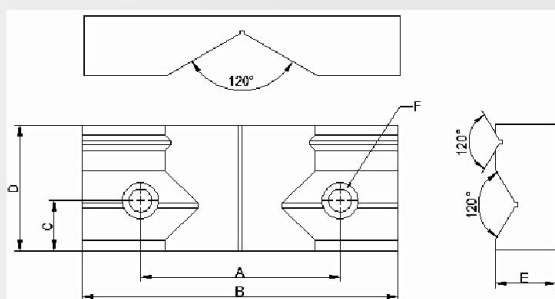
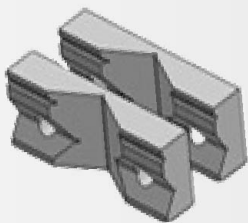

MODEL	A	B	C	D	E	F
J7-100	70	98	25	53	30	M10
J7-130	90	128	25	58	30	M10
J7-160	100	158	25	63	30	M10
J7-200	120	198	30	63	40	M12

FEATURES

- Can be used with Power Machine Vise, depending on the different processing objects, use the appropriate jaw plates to enhance processing efficiency.



UT-TECH

UT-TECH PRECISION INDUSTRIAL CO.,LTD

Taiwan

No.174, Daming Rd., Shengang Dist.,
Taichung City 42942, Taiwan (R.O.C)
TEL:886-04-25276878
FAX:886-04-25206919
E-mail: service@chin-chao.com.tw

China

Room 103, No. 13, Wusha Xing First
Road, Changan Town, Dongguan City,
Guangdong Province
TEL:002-86-13058569292
WECHAT:13058569292

